



LINZMEIER

Insulate with system

Universal
insulation-boards

LINITHERM®

PAL
PGV

The proven insulation system for universal application

For use in construction, vehicle and container building,
tent construction and other custom solutions



Photo: MTH Zeltbau GmbH & Co. KG,
Schechingen (Germany)



Pressure resistant



Permanent thermal
stability

LINITHERM, the high performance insulation material
 λ_D 0.022/0.025/0.026/0.028
W/(mK)

Also as flat roof insulation, core insulation, under screed, insulating attic floors, window reveals, in radiator niches, cold storage rooms

Low structure height and maximum insulation



Meets the QNG requirements for prevention of hazardous substances in insulants. "pure life" is a seal of approval issued by the UGPU association.

www.Linzmeier.de

LINITHERM® PAL and/or PGV – Saving energy is the best environmental relief

At last, you can close the last holes in your thermal protection with LINITHERM Universal insulation boards: Wherever you need good insulation with minimum thickness. Thanks to extremely low thermal conductivity coupled with high insulation performance, board thickness can be kept very low. This is especially advantageous during building modernization, where every millimeter less can be decisive. Moreover, the boards are pressure-resistant and dimensionally stable. They are light, easy to handle, and interlocked fitting is fast, with a minimum of assistance. Standard woodworking tools can be used for cutting the boards to size.

Examples of use



Insulation of the topmost floor ceiling

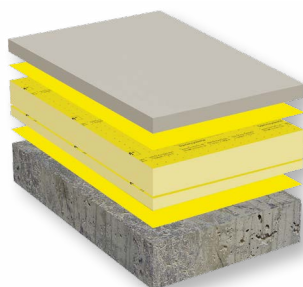

Thermal insulation under the screed or the underfloor heating

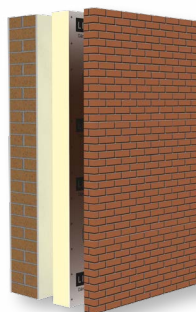

Core insulation in double brickwork

LINITHERM PAL		< 80 mm PH 214000				
Insulation core	PU rigid foam acc. to EN 13165, fire behavior class E acc. to EN 13501-1, coated with aluminum film on both sides					
Edge joints	Thickness 20–40 mm: round about edgeless cut Thickness 50–100 mm: round about edgeless cut or with rabbet edges Thickness 120–240 mm: round about graded notches					
Overall dimension	1200 × 600 mm (= invoicing measurement) (coverage with rabbet edges is 2 cm smaller)					
Thickness mm total	Quantity per package Piece	Quantity per package m ²	Quantity per pallet Piece	Quantity per pallet m ²	λ _D W/(mK)	U-value** [W/(m ² K)]
20	25	18.00	250	180.0	0.022	0.90
30	16	11.52	160	115.2	0.022	0.64
40	12	8.64	120	86.4	0.022	0.50
50	10	7.20	100	72.0	0.022	0.40
60	8	5.76	80	57.6	0.022	0.34
70	7	5.04	70	50.4	0.022	0.30
		≥ 80 mm PH 215000				
80	6	4.32	60	43.2	0.022	0.26
100	5	3.60	50	36.0	0.022	0.21
120	4	2.88	40	28.8	0.022	0.18
140	3	2.16	36	25.9	0.022	0.15
160	3	2.16	30	21.6	0.022	0.13
*180	2	1.44	28	20.2	0.022	0.12
*200	2	1.44	24	17.3	0.022	0.11
*220	2	1.44	20	14.4	0.022	0.10
*240	2	1.44	20	14.4	0.022	0.09

LINITHERM PGV		< 80 mm PH 214000				
Insulation core	PU rigid foam acc. to EN 13165, fire behavior class E acc. to EN 13501-1, coated with mineral fleece on both sides					
Edge joints	Thickness 20–40 mm: round about edgeless cut Thickness 50–100 mm: round about edgeless cut or with rabbet edges Thickness 120–240 mm: round about graded notches					
Overall dimension	1200 × 600 mm (= invoicing measurement) (coverage with rabbet edges is 2 cm smaller)					
Thickness mm total	Quantity per package Piece	Quantity per package m ²	Quantity per pallet Piece	Quantity per pallet m ²	λ _D W/(mK)	U-value** [W/(m ² K)]
20	25	18.00	250	180.0	0.028	1.17
30	16	11.52	160	115.2	0.028	0.83
40	12	8.64	120	86.4	0.028	0.64
50	10	7.20	100	72.0	0.028	0.52
60	8	5.76	80	57.6	0.028	0.44
		≥ 80 mm PH 215000				
80	6	4.32	60	43.2	0.026	0.31
100	5	3.60	50	36.0	0.026	0.25
120	4	2.88	40	28.8	0.025	0.20
140	3	2.16	36	25.9	0.025	0.17
160	3	2.16	30	21.6	0.025	0.15
*180	2	1.44	28	20.2	0.025	0.14
*200	2	1.44	24	17.3	0.025	0.12

Other thicknesses upon request/Delivery only in full packages.

* Might have longer delivery times.
** U-value calculation takes the thermal resistances R_{s1} = 0.1 [m²K/W] and R_{s2} = 0.04 [m²K/W] into account. Building-specific peculiarities for example as per EN ISO 6946 are not taken into account.

Optimal cold protect

Optimal heat protect

Moisture resistant

Maximum insulation with minimum panel thickness

Pressure resistant

Odorless & physiologically free

Recyclable

Environmentally friendly

Cuts costs, ensures excellent ROI

Permanent thermal stability

QNG-ready

DGNB NAVIGATOR

Registrierungs-Code

33XPMX

www.dgnb-navigator.de

LINZMEIER

Insulate with system

Linzmeier Bauelemente GmbH
Industriestraße 21
D-88499 Riedlingen
Tel.: +49 (0) 73 71 18 06-0

Linzmeier Bauelemente GmbH
Schortentalstraße 24
D-07613 Königshofen/Thüringen
Tel.: +49 (0) 3 66 91 7 22-0

Info@Linzmeier.de
www.Linzmeier.de

