

LINITHERM LOOP

Dämmstark. Nachhaltig. Gesünder.

Flat roof insulation
Universal-Dämmplatte

LINITHERM LOOP PAL

- ✓ Lowest thermal conductivity of all bio-based insulation materials
- ✓ Ecologically healthy and free from harmful substances
- ✓ Around 60% biomass*
- ✓ CO₂-neutral production

* PU raw materials according to biomass balance methods or bio-based



Erfüllt die QNG-Anforderungen an Schadstoffvermeidung in Dämmstoffen. „pure life“ ist eine Marke der ÜGPU.



Produkt gelistet im
Navigator



loop.linzmeier.de

LINZMEIER

Insulate with system

LINITHERM LOOP Our recipe for sustainable, ecological building and living.

The thin and lightweight insulation is made from approximately 60 percent biomass* and achieves a U-value of 0.14 W/(m²K) that qualifies for subsidies, even with a 160 mm insulation panel. A building envelope insulated with LINITHERM LOOP significantly reduces heat loss and lowers CO₂ emissions. This thermal insulation creates a healthy indoor climate and comfortable living environment, while simultaneously saving on heating costs and protecting the climate.

The aluminum facings of LINITHERM LOOP products are recyclable. LINITHERM LOOP maintains its consistently high-efficiency insulation properties for the entire lifespan of a building!

The right insulation solution for every roof construction

Flat roof insulation for gravel and terrace

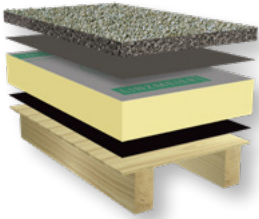

Insulation of the topmost floor ceiling

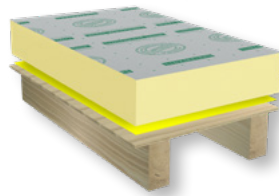

Thermal insulation below the screed or the underfloor heating

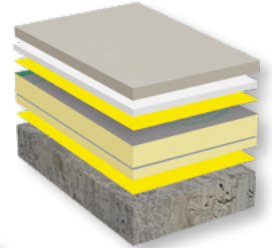

Flat roof insulation for green roof

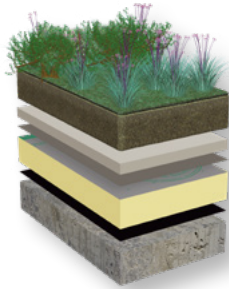

Core insulation in double-shell masonry walls

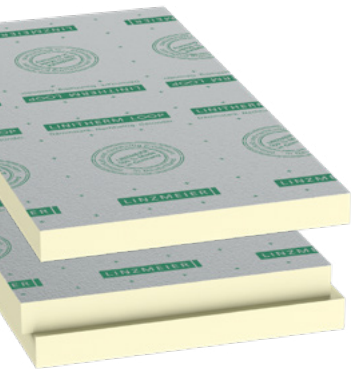
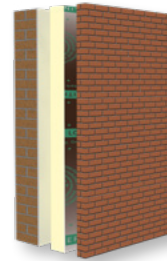

LINITHERM LOOP PAL PH 22500000

Insulation core	PU rigid foam with biomass content acc. to EN 13165, fire behavior class E acc. to EN 13501-1, coated with aluminum film on both sides, low-glare on one side
Edge joints	Thickness 30–100 mm: round about edgeless cut Thickness 80–160 mm: round about rebated joint
Overall dimension	1200 × 600 mm (= calculation measurement) (coverage with rebated joint is 2 cm smaller)

Thickness mm total	Quantity per package		Quantity per pallet		PU λ _D W/(mK)	U-value** [W/(m²K)]
	Piece	m²	Piece	m²		
30	16	11.52	160	115.2	0.022	0.64
50	10	7.20	100	72.0	0.022	0.40
60	8	5.67	80	56.7	0.022	0.34
80	6	4.32	60	43.2	0.022	0.26
100	5	3.60	50	36.0	0.022	0.21
120	4	2.88	40	28.8	0.022	0.18
160	3	2.16	30	21.6	0.022	0.13

Delivery only in full packages.



Optimal cold protection



Optimal heat protection



Moisture resistant



Maximum insulation with minimum panel thickness



Pressure resistant



Odorless & physiologically safe



Recyclable



Positive building biology



Cuts costs, ensures excellent ROI



Long-term resilience to temperature

* PU raw materials according to biomass balance methods or bio-based

** U-value calculation takes the thermal resistances R_{SI} = 0.1 [m²K/W] and R_{SE} = 0.04 [m²K/W] into account. Building-specific characteristics for example as per EN ISO 6946 are not taken into account.

Linzmeier Bauelemente GmbH
Industriestraße 21
88499 Riedlingen
Tel.: +49 (0) 73 71 18 06-0

Info@Linzmeier.de
www.Linzmeier.de

Linzmeier Bauelemente GmbH
Schortentalstraße 24
07613 Königshofen/Thüringen
Tel.: +49 (0) 3 66 91 7 22-0



QR code: Link to the installation instructions



QR code: Link to the technical data sheet



LINZMEIER
Insulate with system

BE / LINITHERM LOOP Flachdach / EN / 2026-05 / pdf
Änderungen vorbehalten