

LINZMEIER

Insulate with system



Price list 1/2026

LINITHERM, LITEC, LINIREC
Prices for retailers (not for end consumer)
Valid from april 15th 2026

Pitched roof

Flat roof

External wall
from outside

Interior

External wall
from inside

Floor
Attic floor

Ceiling

LITEC building
system

LINIREC



U-value-table - Comparison of insulation thickness

Please check which excellent insulation values can be achieved with LINITHERM.
The U-value depends on the thickness of the insulation and the thermal conductivity level.

Panel thickness	LINITHERM PAL LINITHERM LOOP	LINITHERM PGV	Mineral fibre		PS or mineral fibre		PS or mineral fibre		Wood fibre	
	Thermal conductivity λ_D 0.022	Thermal conductivity < 80 mm λ_D 0.028 80-119 mm λ_D 0.026 \geq 120 mm λ_D 0.025	Thermal conductivity λ_D 0.032		Thermal conductivity λ_D 0.035		Thermal conductivity λ_D 0.040		Thermal conductivity λ_D 0.045	
	U-value* insulation	U-value* insulation	U-value* insulation	U-value** insulation between rafters	U-value* insulation	U-value** insulation between rafters	U-value* insulation	U-value** insulation between rafters	U-value* insulation	U-value** insulation between rafters
[mm]	[W/(m ² K)]	[W/(m ² K)]	[W/(m ² K)]	[W/(m ² K)]	[W/(m ² K)]	[W/(m ² K)]	[W/(m ² K)]	[W/(m ² K)]	[W/(m ² K)]	[W/(m ² K)]
20	0.90	1.09	1.21	1.48	1.30	1.55	1.43	1.66	1.55	1.76
30	0.64	0.79	0.88	1.11	0.95	1.16	1.05	1.25	1.15	1.33
40	0.50	0.61	0.69	0.88	0.75	0.93	0.83	1.00	0.92	1.07
50	0.40	0.50	0.57	0.74	0.61	0.78	0.69	0.84	0.76	0.90
60	0.34	0.43	0.48	0.63	0.52	0.67	0.59	0.72	0.65	0.78
70	0.30	0.37	0.42	0.55	0.46	0.58	0.51	0.63	0.57	0.68
80	0.26	0.31	0.37	0.49	0.40	0.52	0.46	0.56	0.51	0.61
100	0.21	0.25	0.30	0.40	0.33	0.43	0.37	0.46	0.41	0.50
120	0.18	0.20	0.25	0.34	0.28	0.36	0.31	0.39	0.35	0.42
140	0.15	0.17	0.22	0.30	0.24	0.31	0.27	0.34	0.30	0.37
160	0.13	0.15	0.19	0.26	0.21	0.28	0.24	0.30	0.27	0.33
180	0.12	0.14	0.17	0.23	0.19	0.25	0.21	0.27	0.24	0.29
200	0.11	0.12	0.16	0.21	0.17	0.22	0.19	0.24	0.22	0.26
220	0.10	0.11	0.14	0.19	0.15	0.21	0.18	0.22	0.20	0.24
240	0.09	0.10	0.13	0.18	0.14	0.19	0.16	0.21	0.18	0.22
260			0.12	0.17	0.13	0.17	0.15	0.19	0.17	0.21
280			0.11	0.15	0.12	0.16	0.14	0.18	0.16	0.19
300			0.10	0.14	0.11	0.15	0.13	0.17	0.15	0.18
320			0.10	0.14	0.11	0.14	0.12	0.16	0.14	0.17
340			0.09	0.13	0.10	0.14	0.12	0.15	0.13	0.16
360			0.09	0.12	0.10	0.13	0.11	0.14	0.12	0.15
380			0.08	0.11	0.09	0.13	0.10	0.13	0.12	0.14

* Thermal conductivity coefficient U includes the thermal resistance ($R_{si} = 0.10$ m²K/W and $R_{se} = 0.10$ m²K/W) in accordance with EN ISO 6946.
** U-value in case of an insulation between rafters with a rafter proportion of 13%.

Pitched roof insulation

bio-based insulation system	4
for old building/restoration	6
for new building	8
in fixed lengths up to 12 metres.....	10
for better noise protection	11
with plasterable, wallpaperable and paintable interior facing	12
for vaulted roofs, dormers.....	13
for metal roofing	14
accessories.....	15

Pitched roof

Flat roof insulation

bio-based insulation system	20
universal + accessories	20
for lightweight industrial roofs + accessories	24
gradient insulation	26
ridge turret – NEW	28
terrace insulation	29

Flat roof

External wall insulation from the outside

external wall insulation from the outside.....	30
--	----

External wall from outside

Interior insulation

interior insulation systems – New format	32
accessories.....	33

Interior

External wall insulation from the inside

external wall insulation from the inside – New format	34
accessories – New format	35
external wall insulation from the inside – New format	36
accessories.....	37

External wall from inside

Floor insulation Attic floor insulation

insulation system of floors.....	38
insulation system for attic floors.....	39
accessories.....	39

Floor
Attic floor

Ceiling insulation

insulation system for underground garages.....	40
accessories.....	41
ecological surface coating	42
accessories.....	43
ceiling insulation – NEW	44
accessories.....	45

Ceiling

LITEC building system

dormer building system, dormer renovation board	46
sky light installation frame	47
parapet element	48
restoration bar	49
accessories.....	50
LITEC flat roof board.....	51

LITEC building system

LINIREC construction board

LINIREC construction board.....	52
Terms of delivery.....	55

LINIREC

Over-rafter insulation system with existing insulation between rafters

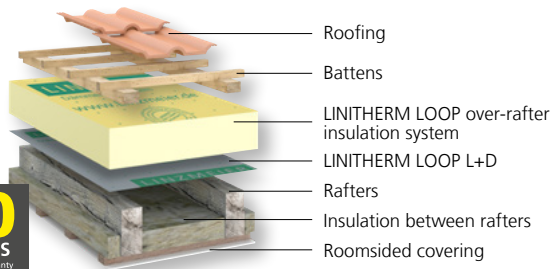

10 YEARS
system warranty



LINITHERM LOOP PAL N+F PH 2200000

Insulation core	PU rigid foam with biomass content acc. to EN 13165, fire behavior class E acc. to EN 13501-1, coated with aluminum film on both sides
Edge joints	Tongue & groove pressfit joints on all sides, plus additional tongue & groove on the long sides with 6 cm overlap
Please note	Joint sealing tape 1060 x 40 mm for sealing the short sides is always included in delivery
Overall dimension	2420 x 1000 mm (= calculation measurement)

Thickness mm	Quantity per pallet		λ_D	U-value**	€/m ²
PU	Piece	m ²	W/(mK)	[W/(m ² K)]	
100	24	58.1	0.022	0.21	36.30
120	20	48.4	0.022	0.18	42.20
140	17	41.1	0.022	0.15	48.00
160	15	36.3	0.022	0.13	53.00
180*	13	31.5	0.022	0.12	57.90



LINITHERM PAL N+F and LINITHERM LOOP PAL N+F – now in the highest hail resistance class 5



During storms, there is often not only storm damage on the building facade, but also increasing hail damage with water ingress and damage to the building.

With the pitched roof insulation systems LINITHERM PAL N+F and LINITHERM LOOP PAL N+F, the highest hail resistance class 5 is achieved.

You can contact your specialist advisor for more information.

1) Roof pitch according to Linzmeier manufacturer recommendation, different pitches are possible after consultation and depending on the specifications of the roof covering.
 * Might have longer delivery times.
 ** U-value, taking the thermal transfer resistance $R_{si} = 0.1$ [m²K/W] and $R_{se} = 0.1$ [m²K/W] acc. to EN ISO 6946 into account.

Over-rafter insulation system

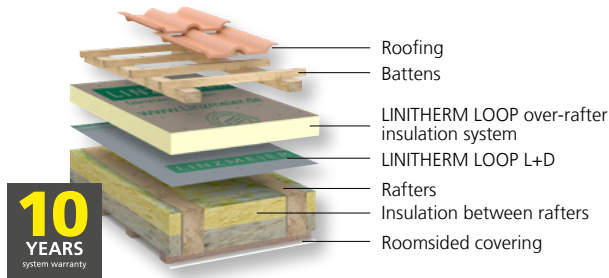

2

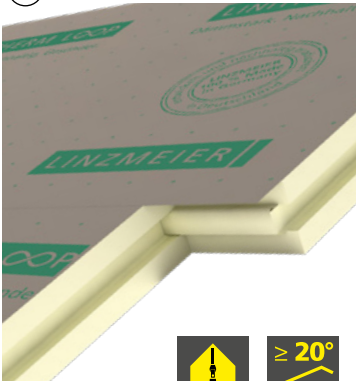

≥ 20°
roof pitch



LINITHERM LOOP PAL 2U

PH 22000020

Insulation core	PU rigid foam with biomass content acc. to EN 13165, fire behavior class E acc. to EN 13501-1, coated with aluminum film on both sides
Facing	Upper side coated with a diffusible, tear-resistant and slip-resistant membrane, approx. 8 cm overlap lengthwise and transverse, plus integrated factory made sealing band
Edge joints	Tongue & groove pressfit joints on all sides
Overall dimension	2420 × 1180 mm (= calculation measurement)

Thickness mm PU	Quantity per pallet Piece	m ²	λ _D W/(mK)	U-value** [W/(m ² K)]	€/m ²
100	24	68.5	0.022	0.21	36.90
120	20	57.1	0.022	0.18	42.90
160	15	42.8	0.022	0.13	53.50
180*	13	37.1	0.022	0.12	58.40



LINITHERM LOOP L+D

PH 22009030

PP-vapour barrier and airtightness membrane for roof, ceiling and wall constructions, Polypropylene nonwoven, fire behavior class E acc. to EN 13501-1, s_D-value 2 m, temperature resistance -30 °C to +80 °C, lengthwise overlapping on both sides, with acrylate-adhesive tape

Width m	Length m	Size roll m ²	Quantity per package	Unit of quantity UQ	€/UQ
1.5	50	75	24 rolls	m ²	3.20

LINITHERM LOOP

Dämmstark. Nachhaltig. Gesünder.

- ✓ Lowest thermal conductivity of all bio-based insulation materials
- ✓ Ecologically healthy and free from harmful substances
- ✓ Suitable for promotion due to best U-values
- ✓ Can be laid on both sides, with little waste
- ✓ Safety in all construction types
- ✓ Highest hail resistance class 5
- ✓ Recyclable aluminium covering
- ✓ Durable (over 50 years)
- ✓ CO₂-neutral production
- ✓ Around 60% biomass



UNSER REZEP T FÜR
NACHHALTIGES, ÖKOLOGISCHES
BAUEN UND WOHNEN
BIOBASIERTE DÄMMSYSTEME

Other thicknesses upon request.

1) Roof pitch according to Linzmeier manufacturer recommendation, different pitches are possible after consultation and depending on the specifications of the roof covering.

* Might have longer delivery times.

** U-value, taking the thermal transfer resistance R_{SE} = 0.1 [m²K/W] and R_{SE} = 0.1 [m²K/W] acc. to EN ISO 6946 into account.

Pitched roof insulation systems for old buildings/restoration

Over-rafter insulation system with roomsided covering

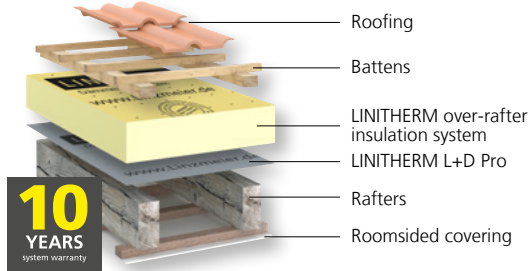

Over-rafter insulation system with existing insulation between rafters

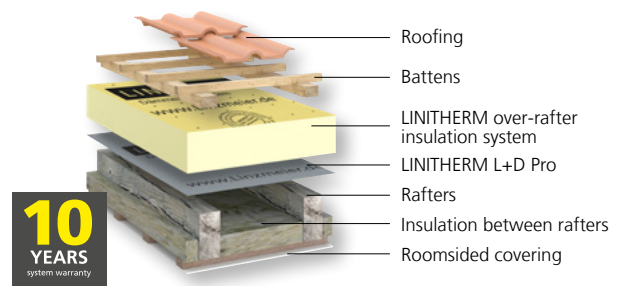

3



LINITHERM PAL N+F PH 21000000

Insulation core	PU rigid foam acc. to EN 13165, fire behavior class E acc. to EN 13501-1, coated with aluminum film on both sides
Edge joints	Tongue & groove pressfit joints on all sides, plus additional tongue & groove on the long sides with 6 cm overlap
Please note	Joint sealing tape 1060 × 40 mm for sealing the short sides is always included in delivery
Overall dimension	2420 × 1000 mm (= calculation measurement)

Thickness mm PU	Quantity per pallet Piece	m ²	λ _D W/(mK)	U-value** [W/(m ² K)]	€/m ²
80*	30	72.6	0.022	0.26	33.20
100	24	58.1	0.022	0.21	39.60
120	20	48.4	0.022	0.18	46.10
140	17	41.1	0.022	0.15	52.30
160	15	36.3	0.022	0.13	57.80
180*	13	31.5	0.022	0.12	63.10
200*	12	29.0	0.022	0.11	68.20
240*	10	24.2	0.022	0.09	78.80

4

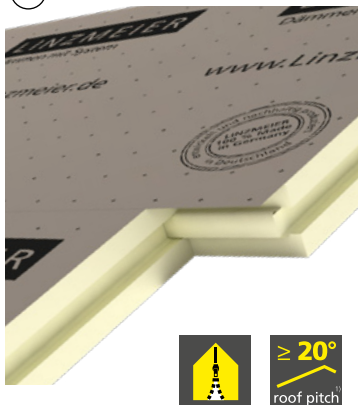

LINITHERM PAL 2U PH 21000020

Insulation core	PU rigid foam acc. to EN 13165, fire behavior class E acc. to EN 13501-1, coated with aluminum film on both sides
Facing	Upper side coated with a diffusible, tear-resistant and slip-resistant membrane, approx. 8 cm overlap lengthwise and transverse, plus integrated factory made sealing band
Edge joints	Tongue & groove pressfit joints on all sides
Overall dimension	2420 × 1180 mm (= calculation measurement)

Thickness mm PU	Quantity per pallet Piece	m ²	λ _D W/(mK)	U-value** [W/(m ² K)]	€/m ²
80	30	85.7	0.022	0.26	33.20
100	24	68.5	0.022	0.21	40.20
120	20	57.1	0.022	0.18	46.80
140	17	48.5	0.022	0.15	53.00
160	15	42.8	0.022	0.13	58.30
180*	13	37.1	0.022	0.12	63.70
200*	12	34.3	0.022	0.11	68.60
240*	10	28.6	0.022	0.09	79.70

5

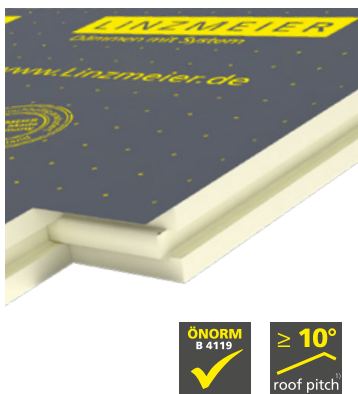

LINITHERM PAL 2U Plus PH 21000025

Insulation core	PU rigid foam acc. to EN 13165, fire behavior class E acc. to EN 13501-1, coated with aluminum film on both sides
Facing	Upper side coated with a diffusible, tear-resistant and slip-resistant membrane, with both sided TPU coating, approx. 10 cm overlap lengthwise and transverse, plus integrated factory made sealing band. (Alternatively, the joint area can be welded to one another with LINITHERM solvent-welding equipment (page 17) or hot air.)
Edge joints	Tongue & groove pressfit joints on all sides
Overall dimension	2420 × 1180 mm (= calculation measurement)

Thickness mm PU	Quantity per pallet Piece	m ²	λ _D W/(mK)	U-value** [W/(m ² K)]	€/m ²
80*	30	85.7	0.022	0.26	36.70
100	24	68.5	0.022	0.21	43.20
120	20	57.1	0.022	0.18	49.80
140	17	48.5	0.022	0.15	55.90
160	15	42.8	0.022	0.13	61.70
180*	13	37.1	0.022	0.12	67.10
200*	12	34.3	0.022	0.11	72.00
240*	10	28.6	0.022	0.09	83.00

Class 1 subroof (with additional measures) acc. to ZVDH guidelines possible.

Other thicknesses upon request.
 1) Roof pitch according to Linzmeier manufacturer recommendation, different pitches are possible after consultation and depending on the specifications of the roof covering.
 * Might have longer delivery times.
 ** U-value, taking the thermal transfer resistance R_{si} = 0.1 [m²K/W] and R_{se} = 0.1 [m²K/W] acc. to EN ISO 6946 into account.



6



LINITHERM PGV T

PH 21000050

Insulation core	PU rigid foam acc. to EN 13165, fire behavior class E acc. to EN 13501-1, coated with mineral fleece on both sides
Facing	Upper side coated with a diffusable, tear-resistant and slip-resistant membrane, approx. 8 cm transverse and lengthwise overlap plus integrated factory-made sealing band
Edge joints	Tongue & groove pressfit joints on all sides
Overall dimension	2420 × 1180 mm (= calculation measurement)

Thickness mm	Quantity per pallet		λ_D	U-value**	€/m ²
PU	Piece	m ²	W/(mK)	[W/(m ² K)]	
50	48	137.1	0.028	0.50	29.40
60	40	114.2	0.028	0.43	31.30
80	30	85.7	0.026	0.31	33.10
100	24	68.5	0.026	0.25	39.50
120	20	57.1	0.025	0.20	44.80
140	17	48.5	0.025	0.17	50.00
160	15	42.8	0.025	0.15	55.30
180*	13	37.1	0.025	0.14	60.60
200*	12	34.3	0.025	0.12	65.30

LITEC restoration bar Fix

PH 31



Insulation core	PU rigid foam acc. to EN 13165, fire behavior class E acc. to EN 13501-1, thickness 60 mm, coated with aluminum film on both sides
Facing	Outside three-layered spruce wood panel, thickness 22 mm
Application	For over-insulating of the airtight connection at verge and eaves. The spruce triple-layer board can be painted, glazed, leaded or clad with slate.

For details see page 49

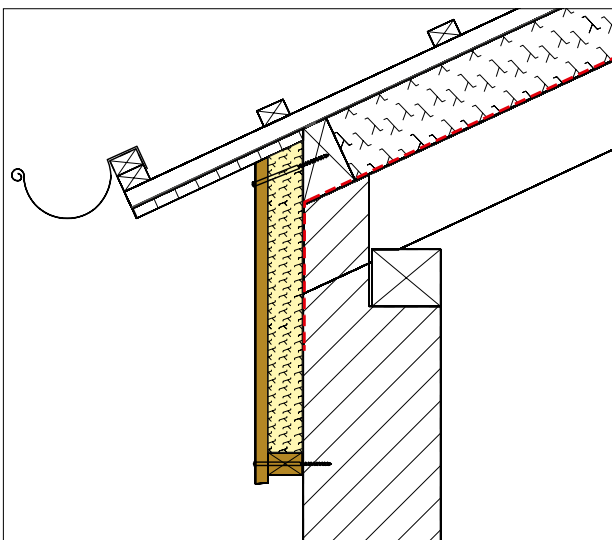

Other thicknesses upon request.

1) Roof pitch according to Linzmeier manufacturer recommendation, different pitches are possible after consultation and depending on the specifications of the roof covering.

* Might have longer delivery times.

** U-value, taking the thermal transfer resistance $R_{si} = 0.1$ [m²K/W] and $R_{se} = 0.1$ [m²K/W] acc. to EN ISO 6946 into account.

Pitched roof insulation systems for new buildings

Over-rafter insulation system with visible rafters

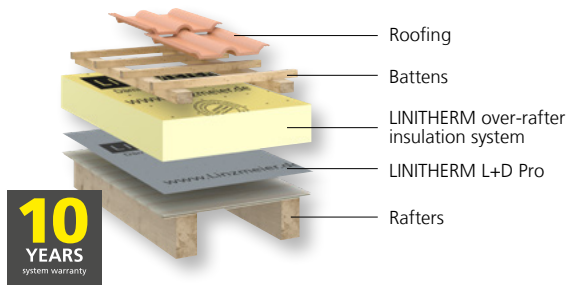

Over-rafter insulation system with roomsided covering

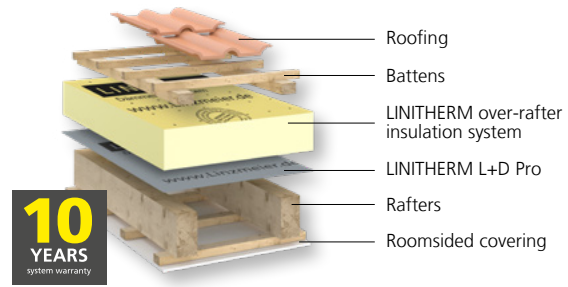

3



LINITHERM PAL N+F

PH 21000000

Insulation core	PU rigid foam acc. to EN 13165, fire behavior class E acc. to EN 13501-1, coated with aluminum film on both sides
Edge joints	Tongue & groove pressfit joints on all sides, plus additional tongue & groove on the long sides with 6 cm overlap
Please note	Joint sealing tape 1060 × 40 mm for sealing the short sides is always included in delivery
Overall dimension	2420 × 1000 mm (= calculation measurement)

Thickness mm PU	Quantity per pallet Piece	m ²	λ _D W/(mK)	U-value** [W/(m ² K)]	€/m ²
80*	30	72.6	0.022	0.26	33.20
100	24	58.1	0.022	0.21	39.60
120	20	48.4	0.022	0.18	46.10
140	17	41.1	0.022	0.15	52.30
160	15	36.3	0.022	0.13	57.80
180*	13	31.5	0.022	0.12	63.10
200*	12	29.0	0.022	0.11	68.20
240*	10	24.2	0.022	0.09	78.80

4

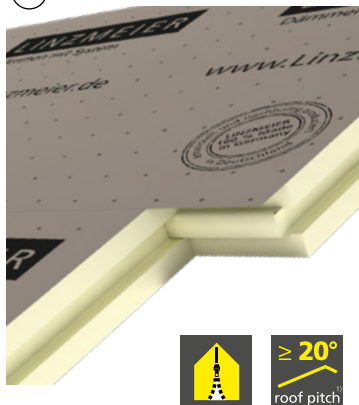

LINITHERM PAL 2U

PH 21000020

Insulation core	PU rigid foam acc. to EN 13165, fire behavior class E acc. to EN 13501-1, coated with aluminum film on both sides
Facing	Upper side coated with a diffusible, tear-resistant and slip-resistant membrane, approx. 8 cm overlap lengthwise and transverse, plus integrated factory made sealing band
Edge joints	Tongue & groove pressfit joints on all sides
Overall dimension	2420 × 1180 mm (= calculation measurement)

Thickness mm PU	Quantity per pallet Piece	m ²	λ _D W/(mK)	U-value** [W/(m ² K)]	€/m ²
80	30	85.7	0.022	0.26	33.20
100	24	68.5	0.022	0.21	40.20
120	20	57.1	0.022	0.18	46.80
140	17	48.5	0.022	0.15	53.00
160	15	42.8	0.022	0.13	58.30
180*	13	37.1	0.022	0.12	63.70
200*	12	34.3	0.022	0.11	68.60
240*	10	28.6	0.022	0.09	79.70

5

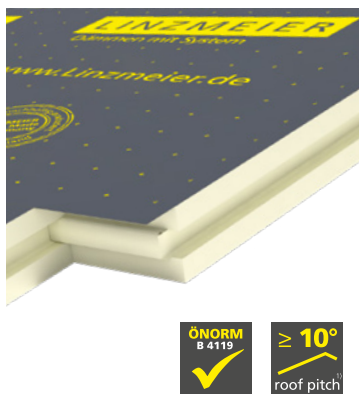

LINITHERM PAL 2U Plus

PH 21000025

Insulation core	PU rigid foam acc. to EN 13165, fire behavior class E acc. to EN 13501-1, coated with aluminum film on both sides
Facing	Upper side coated with a diffusible, tear-resistant and slip-resistant membrane, with both sided TPU coating, approx. 10 cm overlap lengthwise and transverse, plus integrated factory made sealing band. (Alternatively, the joint area can be welded to one another with LINITHERM solvent-welding equipment (page 17) or hot air.)
Edge joints	Tongue & groove pressfit joints on all sides
Overall dimension	2420 × 1180 mm (= calculation measurement)

Thickness mm PU	Quantity per pallet Piece	m ²	λ _D W/(mK)	U-value** [W/(m ² K)]	€/m ²
80*	30	85.7	0.022	0.26	36.70
100	24	68.5	0.022	0.21	43.20
120	20	57.1	0.022	0.18	49.80
140	17	48.5	0.022	0.15	55.90
160	15	42.8	0.022	0.13	61.70
180*	13	37.1	0.022	0.12	67.10
200*	12	34.3	0.022	0.11	72.00
240*	10	28.6	0.022	0.09	83.00

Class 1 subroof (with additional measures) acc. to ZVDH guidelines possible.

Other thicknesses upon request.
 1) Roof pitch according to Linzmeier manufacturer recommendation, different pitches are possible after consultation and depending on the specifications of the roof covering.
 * Might have longer delivery times.
 ** U-value, taking the thermal transfer resistance R_{si} = 0.1 [m²K/W] and R_{se} = 0.1 [m²K/W] acc. to EN ISO 6946 into account.

Over-rafter insulation system with insulation between rafters

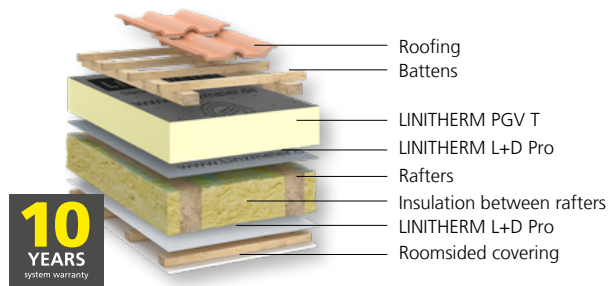

6

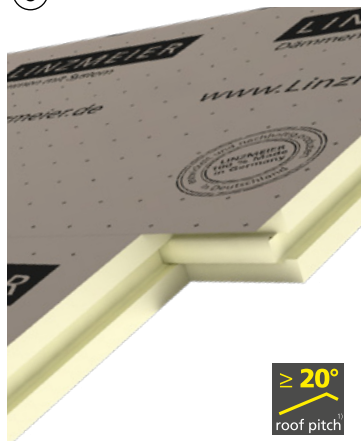

LINITHERM PGV T

PH 21000050

Insulation core	PU rigid foam acc. to EN 13165, fire behavior class E acc. to EN 13501-1, coated with mineral fleece on both sides
Facing	Upper side coated with a diffusable, tear-resistant and slip-resistant membrane, approx. 8 cm transverse and lengthwise overlap plus integrated factory-made sealing band
Edge joints	Tongue & groove pressfit joints on all sides
Overall dimension	2420 × 1180 mm (= calculation measurement)

Thickness mm	Quantity per pallet		λ_D	U-value**	€/m ²
PU	Piece	m ²	W/(mK)	[W/(m ² K)]	
50	48	137.1	0.028	0.50	29.40
60	40	114.2	0.028	0.43	31.30
80	30	85.7	0.026	0.31	33.10
100	24	68.5	0.026	0.25	39.50
120	20	57.1	0.025	0.20	44.80
140	17	48.5	0.025	0.17	50.00
160	15	42.8	0.025	0.15	55.30
180*	13	37.1	0.025	0.14	60.60
200*	12	34.3	0.025	0.12	65.30

THE HEALTHIER ROOF

EXEMPLARY HEALTHIER BUILDING.
SUSTAINABLE HEALTHIER LIVING.

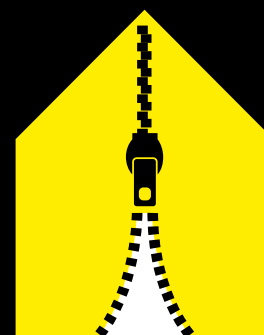

The healthier roof

Our »All in One: Healthier Roof« guarantees that all components – from the roof structure with its internal planking to the substructure, the airtightness, the insulation materials and nail sealing tapes and all the way to the counter-battens and fixing material – are strictly inspected and certified.

LINITHERM manufactures trend-setting products that offer superior technical values and are simple to install – in other words: the perfect recommendation for ensuring a feeling of relaxed well-being in insulated, for healthier living built homes. Innovative, health-checked and responsible.

Completely natural and healthy roofs

Four roof structures have been tested by the SGS Institut Fresenius.

To benefit from the advantages of certification, architects, developers or installers must use all of the building materials listed in the sample structures. In addition to products from the LINITHERM system, this includes the planking, additional insulating materials, adhesives, etc. specified in the component description. The insulation thickness may vary depending on requirements and builders' preferences.

Other thicknesses upon request.

1) Roof pitch according to Linzmeier manufacturer recommendation, different pitches are possible after consultation and depending on the specifications of the roof covering.

* Might have longer delivery times.

** U-value, taking the thermal transfer resistance $R_{si} = 0.1$ [m²K/W] and $R_{se} = 0.1$ [m²K/W] acc. to EN ISO 6946 into account.

Pitched roof insulation systems for new buildings

Over-rafter insulation system with roomsided covering

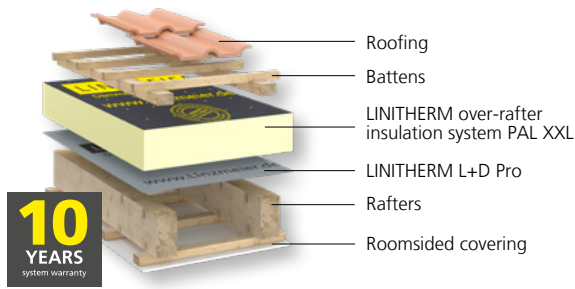

Over-rafter insulation system

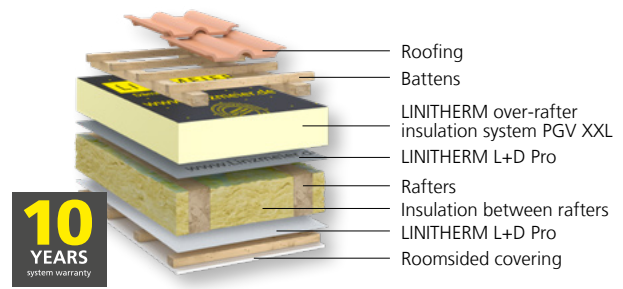

7



LINITHERM PAL XXL

PH 21000080

Insulation core	PU rigid foam acc. to EN 13165, fire behavior class E acc. to EN 13501-1, coated with aluminum film on both sides
Facing	Upper side coated with a diffusible, tear-resistant and slip-resistant membrane with both-sided TPU coating, approx. 10 cm overlap lengthwise, plus integrated factory-made sealing band; (Alternatively, the joint area can be welded to one another with LINITHERM solvent-welding equipment (page 17) or hot air.)
Edge joints	Lengthwise with tongue & groove pressfit joints, transverse with edgeless cut
Fixed length	From 6.00 to max. 12.00 m (minimum 6 elements per fixed length)
Width	1180 mm

Thickness mm total	λ_D W/(mK)	U-value* [W/(m²K)]	€/m²
120	0.022	0.18	upon request
160	0.022	0.13	upon request

Please note delivery times due to property-related manufacturing.

8



LINITHERM PGV XXL

PH 21000085

Insulation core	PU rigid foam acc. to EN 13165, fire behavior class E acc. to EN 13501-1, coated with mineral fleece on both sides
Facing	Upper side coated with a diffusible, tear-resistant and slip-resistant membrane with both-sided TPU coating, approx. 10 cm overlap lengthwise, plus integrated factory-made sealing band; (Alternatively, the joint area can be welded to one another with LINITHERM solvent-welding equipment (page 17) or hot air.)
Edge joints	Lengthwise with tongue & groove pressfit joints, transverse with edgeless cut
Fixed length	From 6.00 to max. 12.00 m (minimum 6 elements per fixed length)
Width	1180 mm

Thickness mm total	λ_D W/(mK)	U-value* [W/(m²K)]	€/m²
160	0.025	0.15	upon request
180	0.025	0.14	upon request

Please note delivery times due to property-related manufacturing.

Lifting support

4 pieces

	Unit of quantity UQ	€/UQ
For thickness 120 mm	piece	25.00
For thickness 160 mm and 180 mm	piece	25.00

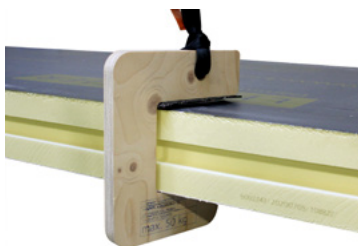

Advantages

- Much more in less time: the extra large size of insulation board allows a very quick installation
- Minimizes joints during installation
- Allows safe insulation of large roof areas
- Ideal for low slope or plane roofs
- Ideal for single or double pitch roofs
- Custom-made insulation boards from 6.00 m to max. 12.00 m



Other thicknesses upon request.

1) Roof pitch according to Linzmeier manufacturer recommendation, different pitches are possible after consultation and depending on the specifications of the roof covering.
 * U-value, taking the thermal transfer resistance $R_{si} = 0.1$ [m²K/W] and $R_{se} = 0.1$ [m²K/W] acc. to EN ISO 6946 into account.

Over-rafter insulation system for improved sound insulation with visible rafters

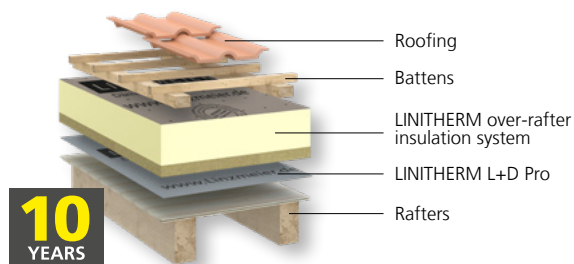

10 YEARS
system warranty

$R_w = 42 \text{ dB}$
acc. to DIN 4109-33:2016-07

9

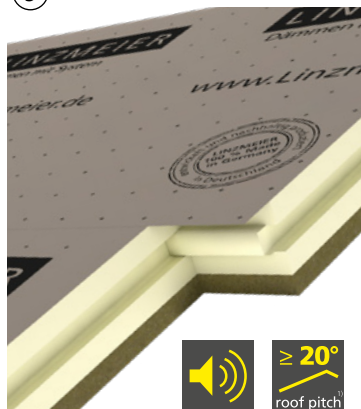

LINITHERM PAL 2UM with soundproofing panel

PH 21001040

Insulation core	PU rigid foam acc. to EN 13165, fire behavior class E acc. to EN 13501-1, coated with aluminum film on both sides
Facing	Upper side covered with a diffusible, tear-resistant, non-slip sarking membrane, approx. 8 cm overlap lengthwise and transverse, plus integrated factory-made sealing band, lower side with a noise protection board, 40 mm to improve sound insulation characteristics
Edge joints	Tongue & groove pressfit joints on all sides
Sound insulation	Thickness 40 mm; $\lambda_D 0,039 \text{ W/(mK)}$
Please note	For improved sound insulation the use of double threaded screws is necessary (see test report)
Overall dimension	2420 x 1180 mm (= calculation measurement)

Thickness mm total	Thickness mm PU	Quantity per pallet Piece	m ²	PU $\lambda_D \text{ W/(mK)}$	U-value** [W/(m ² K)]	€/m ²
140	100	17	48.5	0.022	0.17	65.30
160	120	15	42.8	0.022	0.15	73.20
180	140	13	37.1	0.022	0.13	81.20
200*	160	12	34.3	0.022	0.11	86.50

Other thicknesses upon request.



Other thicknesses upon request.

1) Roof pitch according to Linzmeier manufacturer recommendation, different pitches are possible after consultation and depending on the specifications of the roof covering.

* Might have longer delivery times.

** U-value, taking the thermal transfer resistance $R_{Si} = 0.1 \text{ [m}^2\text{K/W]}$ and $R_{Se} = 0.1 \text{ [m}^2\text{K/W]}$ acc. to EN ISO 6946 into account.

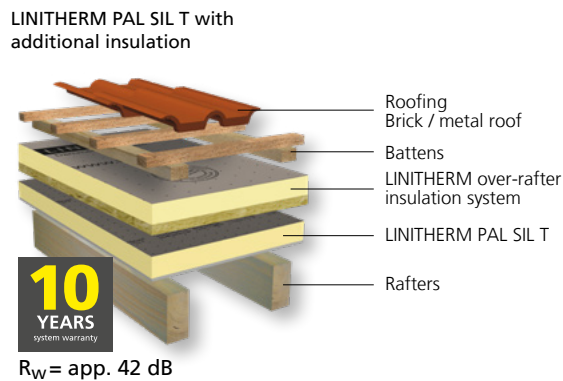
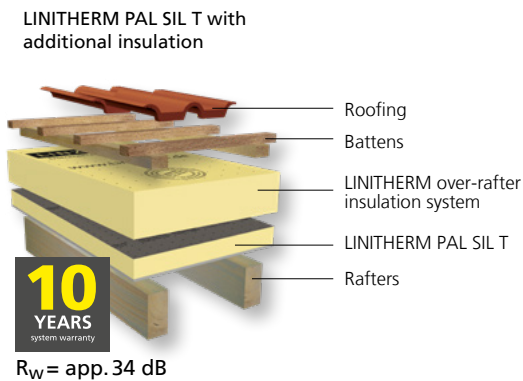

10

New format



≥ 20°
roof pitch

LINITHERM PAL SIL T with T-Membrane

PH 21001000

Insulation core	PU rigid foam acc. to EN 13165, fire behavior class E acc. to EN 13501-1, coated with aluminum film on both sides
Facing	Upper side coated with tear- and slip-resistant membrane, approx. 8 cm overlap lengthwise and transverse, plus integrated factory made sealing band. Inner side with 6 mm thick silicate board (not burnable, resistant to moisture, can be painted, or wallpapered).
Edge joints	Tongue & groove pressfit joints on all sides, silicate board with drywall edge
Overall dimension	2380 × 1180 mm (= calculation measurement)

Thickness mm total	Thickness mm PU	Thickness mm silicate board	Quantity per pallet Piece	λ _D W/(mK)	U-value* [W/(m ² K)]	€/m ²	
66	60	6	36	101.10	0.022	0.34	61.80

Can be combined with insulation systems on page 6 to 9 and page 11.

LINITHERM PAL SIL T with additional insulation

Thickness of overall construction (mm)	Thickness PAL SIL T (λ _D 0.022) (mm)	Thickness of additional insulation (mm)	U-value* [W/(m ² K)]		
			PAL N+F PAL 2U PAL 2U Plus (λ _D 0.022)	PAL 2UM (λ _D 0.022 + 0.039)	PGV T (λ _D 0.028) (λ _D 0.026) (λ _D 0.025)
116	66	50	-	-	0.23
126	66	60	-	-	0.21
146	66	80	0.16	-	0.18
156	66	90	-	-	-
166	66	100	0.14	-	0.16
186	66	120	0.13	0.14	0.14
206	66	140	0.11	0.12	0.12
226	66	160	0.10	0.11	0.11
246	66	180	0.10	0.10	0.10
266	66	200	0.09	-	0.10



Other thicknesses upon request.

1) Roof pitch according to Linzmeier manufacturer recommendation, different pitches are possible after consultation and depending on the specifications of the roof covering.
* U-value, taking the thermal transfer resistance R_{si} = 0.1 [m²K/W] and R_{se} = 0.1 [m²K/W] acc. to EN ISO 6946 into account.

LINITHERM PGV Flex for vaulted roofs with visible rafters

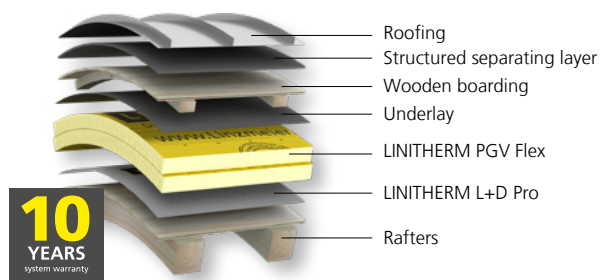

11



LINITHERM PGV Flex PH 21001080

Insulation core	PU rigid foam acc. to EN 13165, fire behavior class E acc. to EN 13501-1, coated with mineral fleece on both sides, insulation elements slotted on both sides
Edge joints	Round about edgeless cut
Please note	When building the sub-roof and the entire roof support structure, the specialist rules of the trade as well as the notes and guidelines in the separate Linzmeier leaflet must be observed.
Overall dimension	2440 × 1200 mm (= calculation measurement)

Thickness mm total	Quantity per pallet		λ_D W/(mK)	U-value [W/(m ² K)]	€/m ²
	Piece	m ²			
60	40	117.1	0.028		33.70
80	30	87.8	0.026		39.50
120 (60 + 60)				0.23	
140 (60 + 80)				0.20	
160 (80 + 80)				0.17	



Pitched roof insulation systems for metal and slate coverings

LINITHERM PAL HW for metal roofs with visible rafters

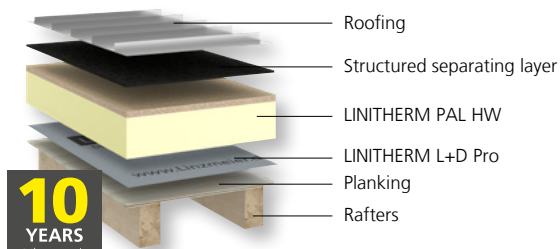

10
YEARS
system warranty

$R_w = \text{app. } 34 \text{ dB}$

LINITHERM PAL HWM for metal roofs with visible rafters

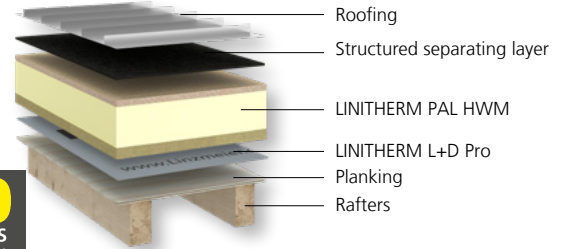

10
YEARS
system warranty

$R_w = \text{app. } 42 \text{ dB}$

12

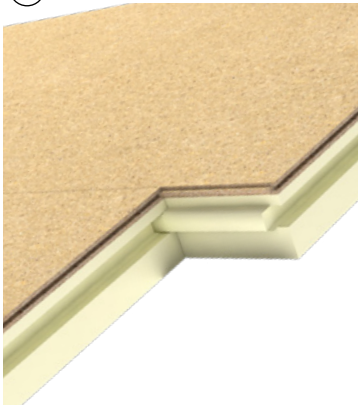

LINITHERM PAL HW

PH 21001060

Insulation core	PU rigid foam acc. to EN 13165, fire behavior class E acc. to EN 13501-1, coated with aluminum film on both sides						
Facing	Covered with a 22 mm derived wood panel for attaching the slates or metal roofing						
Edge joints	Tongue & groove pressfit joints on all sides, derived wood panel with T&G and 2 mm expansion joint						
Please note	When building the sub-roof and the entire roof support structure, the specialist rules of the trade as well as the notes and guidelines in the separate Linzmeier leaflet must be observed.						
Overall dimension	2420 x 580 mm (= calculation measurement)						

Thickness mm total	Thickness mm PU	Thickness mm derived wood panel	Quantity per pallet Piece	λ_D W/(mK)	U-value [W/(m ² K)]	€/m ²	
122	100	22	17	23.9	0.022	0.21	71.50
142	120	22	15	21.1	0.022	0.17	73.90
162	140	22	13	18.2	0.022	0.15	77.30
182	160	22	11	15.4	0.022	0.13	80.40

13



LINITHERM PAL HWM with soundproofing panel

PH 21001060

Insulation core	PU rigid foam acc. to EN 13165, fire behavior class E acc. to EN 13501-1, coated with aluminum film on both sides						
Facing	Covered with a 22 mm derived wood panel for attaching the slates or metal roofing, lower side with a soundproofing panel, 40 mm						
Edge joints	Tongue & groove pressfit joints on all sides, derived wood panel with T&G and 2 mm expansion joint						
Please note	When building the sub-roof and the entire roof support structure, the specialist rules of the trade as well as the notes and guidelines in the separate Linzmeier leaflet must be observed.						
Overall dimension	2420 x 580 mm (= calculation measurement)						

Thickness mm total	Thickness mm PU	Thickness mm derived wood panel	Thickness mm sound insulation	Quantity per pallet Piece	λ_D PU	λ_D sound insulation	U-value [W/(m ² K)]	€/m ²	
142*	80	22	40	15	21.1	0.022	0.039	0.20	82.80
162*	100	22	40	13	18.2	0.022	0.039	0.17	86.40
182*	120	22	40	11	15.4	0.022	0.039	0.15	88.70
202*	140	22	40	10	14.0	0.022	0.039	0.13	92.00
222*	160	22	40	9	12.6	0.022	0.039	0.12	95.30



Other thicknesses upon request.
* Might have longer delivery times.

Airtightness

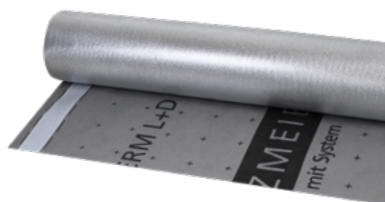

LINITHERM L+D Pro PH 21009030

PP-vapour barrier and airtightness membrane for roof, ceiling and wall constructions, Polypropylene nonwoven, aluminized polypropylene, fire behavior class E acc. to EN 13501-1, s_d -value 2 m, temperature resistance -30 °C to $+80\text{ °C}$, lengthwise overlapping on both sides with acrylate-adhesive tape

Width m	Length m	Size roll m ²	Quantity per package	Unit of quantity UQ	€/UQ
1.5	50	75	24 rolls	m ²	4.00



LINITHERM LOOP L+D PH 22009030

PP-vapour barrier and airtightness membrane for roof, ceiling and wall constructions, Polypropylene nonwoven, fire behavior class E acc. to EN 13501-1, s_d -value 2 m, temperature resistance -30 °C to $+80\text{ °C}$, lengthwise overlapping on both sides, with acrylate-adhesive tape

Width m	Length m	Size roll m ²	Quantity per package	Unit of quantity UQ	€/UQ
1.5	50	75	24 rolls	m ²	4.00

NEW



LINITHERM L+D adhesive tape PH 21009030

For LINITHERM L+D Pro and LINITHERM LOOP L+D, For airtight and windproof bonding **indoors and outdoors**

Width mm	Size roll	Quantity per package	Unit of quantity UQ	€/UQ
60	25	10 rolls	lm	2.20



LINITHERM Dichtfix PH 21009030

LINITHERM Dichtfix is a high performance adhesive binder, which permanently glues vapour barriers and vapour brakes with hard surfaces – without using a pressure lath. LINITHERM Dichtfix can be mixed with water for use as a primer

Size	Consumption with an 8 mm thick bead	Package Content	Unit of quantity UQ	€/UQ	
Cartouche	310 ml	approx. 8 lm	12 cartouches	piece	11.20



LINITHERM compriband PH 21009030

For sealing the gap between masonry and insulation, compress to about 30% when installed impregnated, and one side self-adhesive

Original thickness × selfadhesive width mm	For joints up to mm	Pre-compressed delivery format mm	Size roll m	Quantity per package lm	Unit of quantity UQ	€/UQ
20 × 15	3–7	4 × 15	6.0	120.0	lm	3.50
40 × 20	7–12	8 × 20	5.0	75.0	lm	6.60
60 × 30	10–18	12 × 30	5.0	50.0	lm	12.50

Sealing



LINITHERM 1K-PU-pistol foam PH 21009000

LINITHERM filling and sealing foam, incl. recycling fee

Consumption for approx. 10 mm joint width	Size Content	Quantity per package	Unit of quantity UQ	€/UQ
Approx. 10–12 lm	Can 750 ml	12 cans	piece	11.50



Joint tape for LINITHERM PAL N+F and LINITHERM LOOP PAL N+F PH 21009000

Application recommendation For pitched roof insulation system ① ③
For sealing the short sides

Quantity required 1 piece per element

Width mm	Length mm	Size bundle	Unit of quantity UQ	€/UQ
40	1060	5	piece	2.50



Adhesive tape BK PH 21009020

Application recommendation For pitched roof insulation system ① ③
Butyl rubber, 1 mm thick, for sealing coves, ridges, etc.

Width mm	Size roll m	Quantity per package	Unit of quantity UQ	€/UQ
200	10	5 rolls	lm	8.60
300	10	2 rolls	lm	14.60



T-Adhesive tape PH 21009020

Application recommendation For pitched roof insulation system ② ④ ⑤ ⑥ ⑦ ⑧ ⑨
Polyacrylate adhesive tape

Width mm	Size roll m	Quantity per package	Unit of quantity UQ	€/UQ
200	25	4 rolls	lm	4.90

Sealing

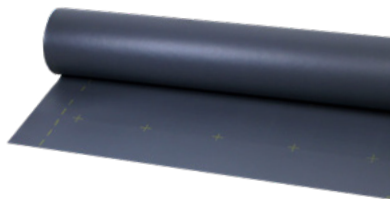

LINITHERM U Plus membrane PH 21009020

Application recommendation Diffusible membrane with TPU coating on both sides for warm welding and solvent welding, fire behavior class E acc. to EN 13501-1, temperature resistance –30 °C to +80 °C, resistance against water penetration W1

Width m	Length m	Size roll m ²	Quantity per pallet	Unit of quantity UQ	€/UQ
1.5	50	75	20 rolls	m ²	13.10



LINITHERM UD-cover stripe PH 21009020

Application recommendation For pitched roof insulation system ⑤⑦⑧ Diffusible welding strip with TPU coating for warm welding and solvent welding on premium underlay membrane, fire behavior class E acc. to EN 13501-1, temperature resistance –30 °C to +80 °C, resistance against water penetration W1

Width mm	Size roll m	Quantity per package	Unit of quantity UQ	€/UQ
300	25	5 rolls	lm	5.50



LINITHERM solvent welding agent PH 21009020

Application recommendation For pitched roof insulation system ⑤⑦⑧ and U Plus membrane/ UD- cover stripes Solvent-welding agent (THF) for welding of the LINITHERM UD-cover stripe with the LINITHERM premium underlay sheet. The solvent-welding agent is applied by a bottle with brush. Consumption: approx. 5–10 g/lm. Use only in case of dry underground and at temperatures above 5 °C.

Can Size	Quantity per package	Unit of quantity UQ	€/UQ
1 l	10 cans	piece	59.50



LINITHERM bottle with brush PH 21009020

Application For application of the LINITHERM solvent welding agent with brush

Unit of quantity UQ	€/UQ
piece	41.80



Connection tube for insulation DG PH 21009040

Application recommendation For rainproof, wind- and air-tight penetration of pitched roofs with over-rafter insulation. The specially angled bottom section with a flexible hose connection permits trouble-free installation in the space between rafters. For roof vent diameters Ø 100 mm, 125 mm, 150 mm.

Unit of quantity UQ	€/UQ
piece	160.90

Attachment



LINIFIX special screws PH 21009010

Application recommendation	With technical approval, for fixing the counter-battens (40 × 60 or 40 × 80 mm) and the LINITHERM PU insulating elements, continuously at an angle of 67°
Quantity required	Approx. 1.5–2.5 pieces per m ²

Structural height *	Ø × Length mm	Size Content	Unit of quantity UQ	€/UQ
Insulation 50 mm	8.0 × 180	50 pieces/package	piece	1.20
Insulation 80 mm	8.0 × 200	50 pieces/package	piece	1.30
Insulation 80/100 + boarding 19 mm	8.0 × 225	50 pieces/package	piece	1.40
Insulation 120 + boarding 19 mm	8.0 × 250	50 pieces/package	piece	1.60
Insulation 140 + boarding 19 mm	8.0 × 275	50 pieces/package	piece	1.70
Insulation 160 + boarding 19 mm	8.0 × 300	50 pieces/package	piece	1.80
Insulation 180 + boarding 19 mm	8.0 × 325	50 pieces/package	piece	2.00
Insulation 200 + boarding 19 mm	8.0 × 350	50 pieces/package	piece	2.10
Insulation 220 + boarding 19 mm	8.0 × 375	50 pieces/package	piece	2.40
Insulation 240 + boarding 19 mm	8.0 × 400	50 pieces/package	piece	2.50

* Rafter spacing ≤ 0.75 m; snow load 0.65 kN/m²; weight of covering 0.55 kN/m².
Every package includes 1 free bit; 1 free screw template is included per delivery.

LINIFIX dual-thread screws PH 21009010



Application recommendation	For pitched roof insulation system ⑨ With technical approval, for fixing the counter-battens (40 × 60 or 40 × 80 mm) and the LINITHERM PU insulating elements
Quantity required	Approx. 2.5 pieces per m ²

Structural height **	Ø × Length mm	Size Content	Unit of quantity UQ	€/UQ
Insulation 140 mm	8.0 × 275	50 pieces/package	piece	3.70
Insulation 160 mm	8.0 × 302	50 pieces/package	piece	3.80
Insulation 180 mm	8.0 × 335	50 pieces/package	piece	4.10
Insulation 200 mm	8.0 × 365	50 pieces/package	piece	5.20
Insulation 220 mm	8.0 × 397	50 pieces/package	piece	7.40

** Length of the screws by installation on 19 mm boarding
Note the special statics for PAL ZUM elements with soundproofing panel.

LINIFIX IngBau screws PH 21009010



Application recommendation	For pitched roof insulation system ⑫ ⑬
Quantity required	Approx. 5 pieces per m ²

Structural height ***	Ø × Length mm	Size Content	Unit of quantity UQ	€/UQ
102/122 mm	8.0 × 220	50 pieces/package	piece	1.70
142 mm	8.0 × 240	50 pieces/package	piece	1.80
162 mm	8.0 × 260	50 pieces/package	piece	2.00
182 mm	8.0 × 280	50 pieces/package	piece	2.10
202 mm	8.0 × 300	50 pieces/package	piece	2.20
222 mm	8.0 × 320	50 pieces/package	piece	2.40

*** Length of the screws by installation on 24 mm boarding.

Sealing



Nail sealing tape PP PH 21009020

Application	Polypropylene, for permanent sealing of nail or screw penetrations below the counter batten.
--------------------	--

Thickness mm	Width mm	Size roll m	Packages Content	Unit of quantity UQ	€/UQ
3	60	30	10 rolls	lm	1.20



Nail sealing tape BK PH 21009020

Application	Butyl rubber, for permanent sealing of nail or screw penetrations below the counter batten.
--------------------	---

Thickness mm	Width mm	Size roll m	Packages Content	Unit of quantity UQ	€/UQ
3	50	15	6 rolls	lm	2.30

Others



LINITHERM WDU-profile for class 1 sub-roof (Acc. to ZVDH guidelines) PH 21009020

Made of LINIREC construction boards, 80 × 20 mm, long sides bevelled and with 3 holes, for waterproof sub-roof below the sealing

Thickness mm	Width mm	Length mm	Unit of quantity UQ	€/UQ
20	80	2440	lm	13.30

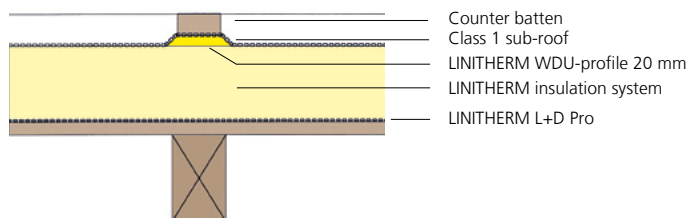

Roof window insulating frame



LINITHERM DDZ Velux roof window insulating frame PH 21009040

Insulation core LINIREC construction board, raw density approx. 550 kg/m³, fire behavior class E acc. to EN 13501-1, rated value of thermal conductivity λ_D 0.083 W/(mK), can be used in temperature range of -50 °C to +100 °C, moisture resistant, no mould formation, does not rot

Please note Use only for Velux roof windows

Thickness mm Counter batten	Thickness mm roof batten	Width mm total	Width mm batten covering	Width mm Roof window covering	Length mm	Unit of quantity UQ	€/UQ
40	30	110	50	60	2440	lm	33.90
40	40	110	50	60	2440	lm	35.20

Other thicknesses upon request.

Accessories for roof window insulating frame



Adhesive tape BK PH 21009020

Application recommendation Butyl rubber, 1 mm thick, for sealing coves, ridges, etc.

Width mm	Size roll m	Quantity per package	Unit of quantity UQ	€/UQ
200	10	5 rolls	lm	8.60
300	10	2 rolls	lm	14.60



Bio-based flat roof insulation and terrace insulation

Flat roof insulation LINITHERM for green roof

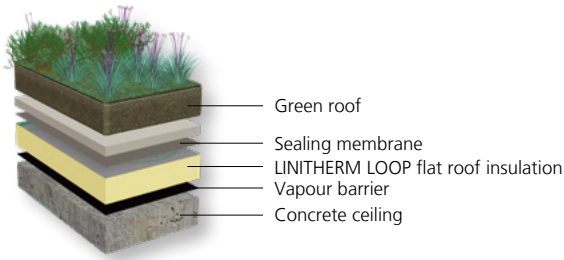

Flat roof insulation LINITHERM for gravel roof on wooden construction

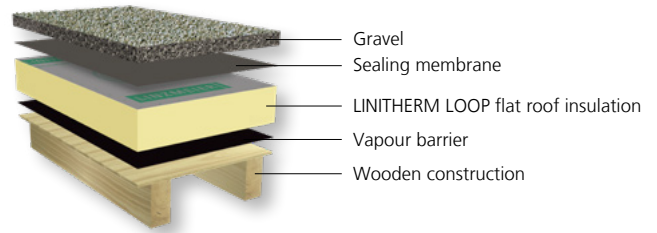

Flat roof

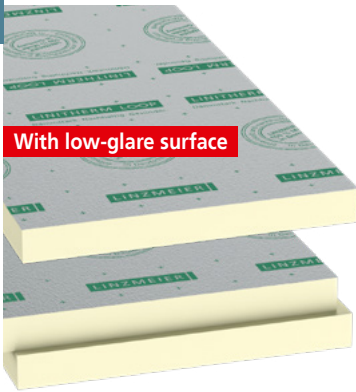

LINITHERM LOOP PAL PH 22500000

Insulation core	PU rigid foam with biomass content acc. to EN 13165, fire behavior class E acc. to EN 13501-1, coated with aluminum film on both sides, low-glare on one side						
Edge joints	Thickness 30 – 100 mm: round about edgeless cut Thickness 80 – 160 mm: round about rebated joint						
Overall dimension	1200 x 600 mm (= calculation measurement) (coverage with rebated joint is 2 cm smaller)						
Thickness mm total	Quantity per package Piece	Quantity per package m ²	Quantity per pallet Piece	Quantity per pallet m ²	λ_D W/(mK)	U-value* [W/(m ² K)]	€/m ²
30	16	11.52	160	115.2	0.022	0.64	15.00
50	10	7.20	100	72.0	0.022	0.40	19.60
60	8	5.67	80	56.7	0.022	0.34	22.70
80	6	4.32	60	43.2	0.022	0.26	26.40
100	5	3.60	50	36.0	0.022	0.21	31.70
120	4	2.88	40	28.8	0.022	0.18	37.60
160	3	2.16	30	21.6	0.022	0.13	49.60

Delivery only in full packages.



+ FLAT ROOF SOLUTIONS

LINITHERM LOOP PAL Flat roof



- ✓ Low weight
- ✓ Low-glare on one side
- ✓ High pressure resistance
- ✓ Dimensionally accurate & stable
- ✓ Moisture resistant

LINITHERM LOOP PAL gradient

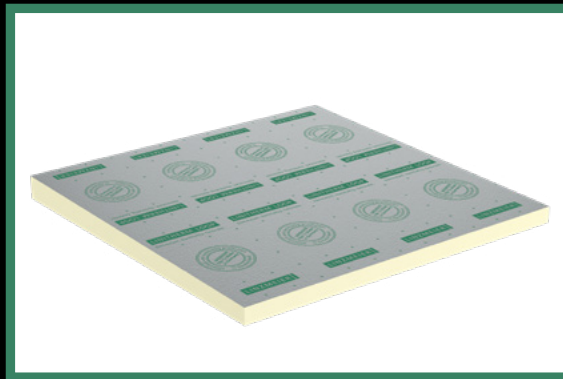

- ✓ Suitable for sealing with bitumen and plastic membranes
- ✓ Dimensionally accurate & stable
- ✓ Low-glare on one side
- ✓ Standard gradient of 2% meets the flat roof guidelines
- ✓ Simple gradient plan and order-based picking
- ✓ TCL 023 full-surface, thin overall structure

* U-value calculation takes the thermal resistances $R_{si} = 0.1$ [m²K/W] and $R_{se} = 0.04$ [m²K/W] into account. Building-specific characteristics for example as per EN ISO 6946 are not taken into account.

Gradient insulation LINITHERM
PAL gradient with gravel on concrete

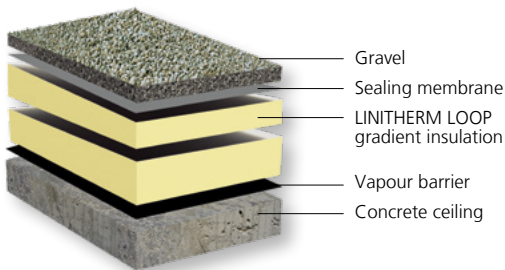

Advantages of the modular system

- Offers a variety of installation possibilities and drainage methods
- Gradient, ridge, valley and universal boards can be easily assembled
- Short delivery times due to fast availability of all necessary parts
- Quick and easy installation
- Consistently the same surface and TCL
- Time and cost savings

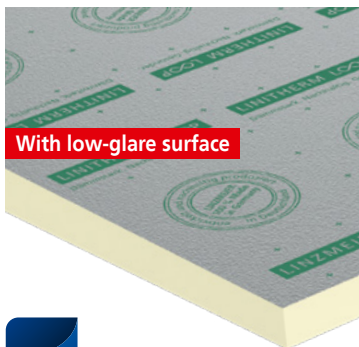
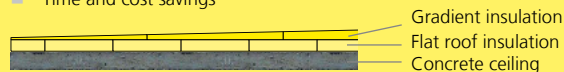

LINITHERM LOOP PAL gradient

PH 22502010

Insulation core	PU rigid foam with biomass content acc. to EN 13165, fire behavior class E acc. to EN 13501-1, coated with aluminum film on both sides, low-glare on one side
Edge joints	Round about edgeless cut
Overall dimension	1200 × 1200 mm

Thickness mm total	Gradient %	Quantity per pallet Piece	m ²	λ _D W/(mK)	€/m ²
30/55	2	48	69.1	0.022	29.00
55/80	2	32	46.1	0.022	39.10
80/105	2	24	34.6	0.022	48.40
105/130	2	20	28.8	0.022	57.60

LINITHERM LOOP PAL gradient ridge board 45° angle

PH 22502020

Set consisting of ridge board left and ridge board right, low-glare on one side

Thickness mm total	Gradient %	Quantity per pallet Sets	λ _D W/(mK)	€/Set
30/55	2	32	0.022	52.10
55/80	2	24	0.022	67.10
80/105	2	20	0.022	82.10
105/130	2	16	0.022	98.50

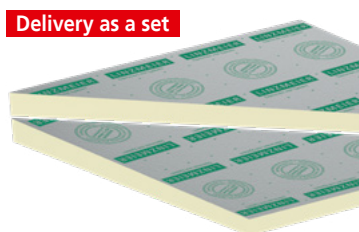

Delivery as a set

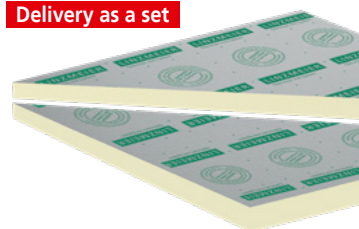

LINITHERM LOOP PAL gradient valley board 45° angle

PH 22502020

Set consisting of valley board left and valley board right, low-glare on one side

Thickness mm total	Gradient %	Quantity per pallet Sets	λ _D W/(mK)	€/Set
30/55	2	32	0.022	52.10
55/80	2	24	0.022	67.10
80/105	2	20	0.022	82.10
105/130	2	16	0.022	98.50

Layering principle: LINITHERM gradient insulation plus flat roof insulation

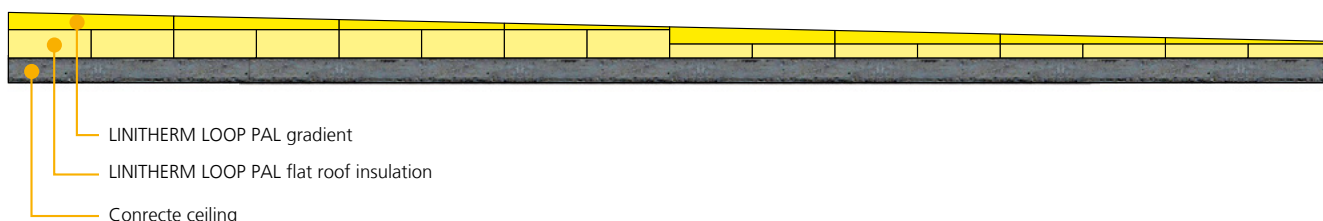

Flat roof insulation and terrace insulation

Flat roof insulation LINITHERM for green roof

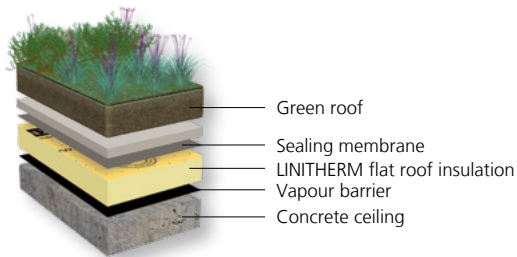

Flat roof insulation LINITHERM for gravel roof on wooden construction

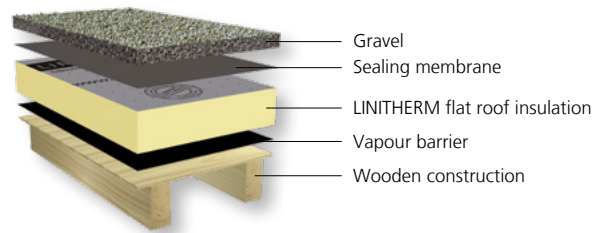

Flat roof

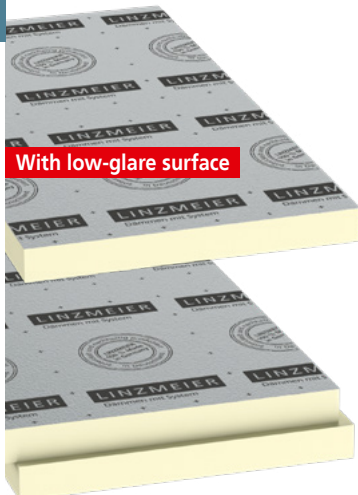

LINITHERM PAL < 80 mm PH 21400000

Insulation core	PU rigid foam acc. to EN 13165, fire behavior class E acc. to EN 13501-1, coated with aluminum film on both sides, low-glare on one side
Edge joints	Thickness 20–30 mm: round about edgeless cut Thickness 40–240 mm: round about edgeless cut or with rebated joint
Overall dimension	1200 × 600 mm (= calculation measurement) (coverage with rebated joint is 2 cm smaller)

Thickness mm total	Quantity per package Piece	Quantity per package m ²	Quantity per pallet Piece	Quantity per pallet m ²	λ _D W/(mK)	U-value** [W/(m ² K)]	€/m ²
20	25	18.00	250	180.0	0.022	0.90	11.50
30	16	11.52	160	115.2	0.022	0.64	13.60
40	12	8.64	120	86.4	0.022	0.50	15.60
50	10	7.20	100	72.0	0.022	0.40	17.80
60	8	5.76	80	57.6	0.022	0.34	20.60
70	7	5.04	70	50.4	0.022	0.30	22.80

>= 80 mm PH 21500000

80	6	4.32	60	43.2	0.022	0.26	24.00
100	5	3.60	50	36.0	0.022	0.21	28.80
120	4	2.88	40	28.8	0.022	0.18	34.20
140	3	2.16	36	25.9	0.022	0.15	39.70
160	3	2.16	30	21.6	0.022	0.13	45.10
180*	2	1.44	28	20.2	0.022	0.12	50.30
200*	2	1.44	24	17.3	0.022	0.11	55.70
220*	2	1.44	20	14.4	0.022	0.10	60.70
240*	2	1.44	20	14.4	0.022	0.09	65.90

Additional price for rebated joint per m² net + 0.30

Other thicknesses upon request/Delivery only in full packages.

LINITHERM PGV < 80 mm PH 21400010

Insulation core	PU rigid foam acc. to EN 13165, fire behavior class E acc. to EN 13501-1, coated with mineral fleece on both sides
Edge joints	Thickness 20–40 mm: round about edgeless cut Thickness 50–200 mm: round about rebated joint
Overall dimension	1200 × 600 mm (= calculation measurement) (coverage with rebated joint is 2 cm smaller)

Thickness mm total	Quantity per package Piece	Quantity per package m ²	Quantity per pallet Piece	Quantity per pallet m ²	λ _D W/(mK)	U-value** [W/(m ² K)]	€/m ²
20	25	18.00	250	180.0	0.028	1.17	11.00
30	16	11.52	160	115.2	0.028	0.83	13.10
40	12	8.64	120	86.4	0.028	0.64	15.10
50	10	7.20	100	72.0	0.028	0.52	17.30
60	8	5.76	80	57.6	0.028	0.44	20.10

>= 80 mm PH 21500010

80	6	4.32	60	43.2	0.026	0.31	23.50
100	5	3.60	50	36.0	0.026	0.25	28.30
120	4	2.88	40	28.8	0.025	0.20	33.70
140	3	2.16	36	25.9	0.025	0.17	39.20
160	3	2.16	30	21.6	0.025	0.15	44.60
180*	2	1.44	28	20.2	0.025	0.14	49.80
200*	2	1.44	24	17.3	0.025	0.12	55.20

Additional price for rebated joint per m² net + 0.30

Other thicknesses upon request/Delivery only in full packages.



* Might have longer delivery times.
** U-value calculation takes the thermal resistances R_{si} = 0.1 [m²K/W] and R_{se} = 0.04 [m²K/W] into account. Building-specific characteristics for example as per EN ISO 6946 are not taken into account.

Accessories



LINITHERM PUR wedge Attica-wedge (trapezoidal) PH 21509010

Insulation core	PU rigid foam acc. to EN 13165, fire behavior class E acc. to EN 13501-1
Length	1200 mm

Measurement mm	Quantity per package	λ_D W/(mK)	€/lm
50 x 50	100	0.028	2.30
80 x 80	72	0.028	3.10
100 x 100	50	0.028	4.10

Full wedge or other thicknesses upon request/Delivery only in full packages.



LINITHERM PE vapour control layer 120 PH 21209000

PE vapour control layer according to EN 13984, suitable for new buildings and restoration, s_d -value 120 m \pm 10, of low fire load, fire behavior class E, weight 150 g/m² \pm 10, colour yellow

Width / m	Length / m	Size/Roll m ²	Unit of quantity/UQ	€/UQ
4	25	100	m ²	1.40



LINITHERM PE vapour control layer 220 PH 21509020

PE vapour control layer according to EN 13984, suitable for new buildings and restoration, s_d -value 220 m \pm 10, of low fire load, fire behavior class E, weight 210 g/m² \pm 10, colour grey

Width / m	Length / m	Size/Roll m ²	Unit of quantity/UQ	€/UQ
4	25	100	m ²	2.20



Adhesive foam/Foam gun PH 21509020

Moisture-hardening single-component adhesive on a polyurethane basis for the gluing of insulation boards for flat roofs and gradient roofs, can be applied from -5 °C ambient temperature or +5 °C can temperature, flexible and not embrittling

	Size/Content	Scope per can	Quantity per package	Unit of quantity/UQ	€/UQ
Adhesive foam	850 ml	approx. 10–14 m ²	12 cans	piece	19.80

Foam gun	Foam gun for the upright dispensing of foam and adhesive foam, pistol length 100 cm			piece	179.10
----------	---	--	--	-------	--------



Flat roof insulation – Lightweight industrial roofs

LINITHERM PAL FD for metal roofs

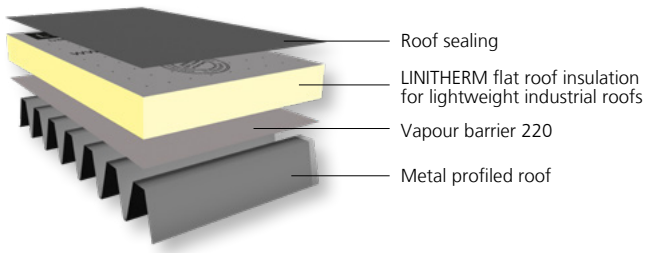

Extremely thin, light, and safe – the high-performance insulation for roofs in lightweight metal construction

- Excellent insulation values
- Minimum panel thickness
- High compressive strength
- Light weight and manageable
- Good fire protection properties – meets the fire protection requirements acc. to DIN 18234-1
- Fast and easy handling & processing
- Mechanical fastening required

Flat roof

LINITHERM PAL FD

PH 21501000

Insulation core	PU rigid foam acc. to EN 13165, fire behavior class E acc. to EN 13501-1, coated with aluminum film on both sides, low-glare on one side
Edge joints	Round about rebated joint
Overall dimension	2440 × 1200 mm (= calculation measurement) (coverage with rebated joint is 2 cm smaller)

Thickness mm total	Quantity per pallet Piece	m ²	λ _D W/(mK)	U-value** [W/(m ² K)]	€/m ²
80	30	87.8	0.022	0.26	24.00
100	24	70.3	0.022	0.21	28.80
120	20	58.6	0.022	0.18	34.20
140	17	49.8	0.022	0.15	39.70
160	15	43.9	0.022	0.13	45.10
180*	13	38.1	0.022	0.12	50.30
200*	12	35.1	0.022	0.11	55.70

Other thicknesses upon request.

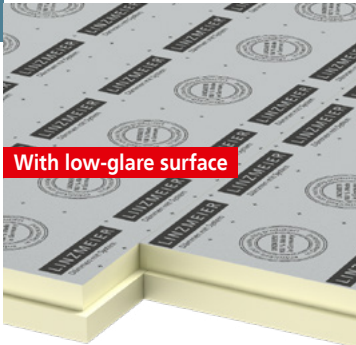

Produkt gelistet im
DGNB Navigator

Flame resistant



LINITHERM PAL FD-C

PH 21501020

Insulation core	PU rigid foam acc. to EN 13165, fire behavior class C-s2,d0 acc. to EN 13501-1, coated with aluminum film on both sides, low-glare on one side
Edge joints	Round about rebated joint
Overall dimension	2440 × 1200 mm (= calculation measurement) (coverage with rebated joint is 2 cm smaller)

Thickness mm total	Quantity per pallet Piece	m ²	λ _D W/(mK)	U-value** [W/(m ² K)]	€/m ²
80*	30	87.8	0.022	0.26	25.70
100*	24	70.3	0.022	0.21	30.80
120*	20	58.6	0.022	0.18	36.60
140*	17	49.8	0.022	0.15	42.50
160*	15	43.9	0.022	0.13	48.30



Produkt gelistet im
DGNB Navigator

* Might have longer delivery times.

** U-value calculation takes the thermal resistances R_{si} = 0.1 [m²K/W] and R_{se} = 0.04 [m²K/W] into account. Building-specific characteristics for example as per EN ISO 6946 are not taken into account.

Accessories



LINITHERM PUR wedge Attica-wedge (trapezoidal) PH 21509010

Insulation core	PU rigid foam acc. to EN 13165, fire behavior class E acc. to EN 13501-1
Length	1200 mm

Measurement mm	Quantity per package	λ_D W/(mK)	€/lm
50 x 50	100	0.028	2.30
80 x 80	72	0.028	3.10
100 x 100	50	0.028	4.10

Full wedge or other thicknesses upon request/Delivery only in full packages.



LINITHERM PE vapour control layer 120 PH 21209000

PE vapour control layer according to EN 13984, suitable for new buildings and restoration, s_d -value 120 m \pm 10, of low fire load, fire behavior class E, weight 150 g/m² \pm 10, colour yellow

Width / m	Length / m	Size/Roll m ²	Unit of quantity/UQ	€/UQ
4	25	100	m ²	1.40



LINITHERM PE vapour control layer 220 PH 21509020

PE vapour control layer according to EN 13984, suitable for new buildings and restoration, s_d -value 220 m \pm 10, of low fire load, fire behavior class E, weight 210 g/m² \pm 10, colour grey

Width / m	Length / m	Size/Roll m ²	Unit of quantity/UQ	€/UQ
4	25	100	m ²	2.20



Adhesive foam / Foam gun PH 21509020

Moisture-hardening single-component adhesive on a polyurethane basis for the gluing of insulation boards for flat roofs and gradient roofs, can be applied from -5 °C ambient temperature or +5 °C can temperature, flexible and not embrittling

	Size/Content	Scope per can	Quantity per package	Unit of quantity/UQ	€/UQ
Adhesive foam	850 ml	approx. 10–14 m ²	12 cans	piece	19.80
Foam gun	Foam gun for the upright dispensing of foam and adhesive foam, pistol length 100 cm			piece	179.10



Flat roof insulation – Gradient insulation

Gradient insulation LINITHERM
PAL gradient with gravel on concrete

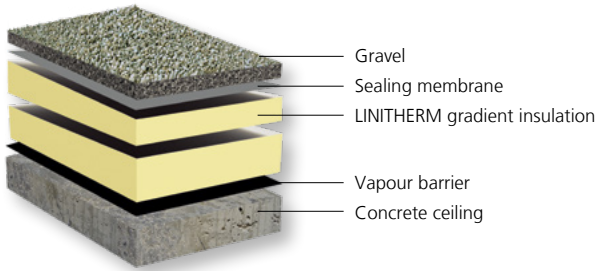

Advantages of the modular system

- Offers a variety of installation possibilities and drainage methods
- Gradient, ridge, valley and universal boards can be easily assembled
- Short delivery times due to fast availability of all necessary parts
- Quick and easy installation
- Consistently the same surface and TCL
- Time and cost savings



Flat roof

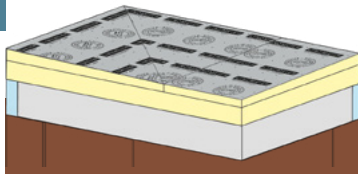

LINITHERM PAL gradient insulation system for flat roofs

PH 21502010

Gradient insulation system, consisting of basic insulation LINITHERM PAL (in case of multi-layer application), LINITHERM PAL gradient from 30 mm up to 230 mm and LINITHERM PAL ridge/valley boards, according to gradient plan, description of the system components: see page 24 and 26

	Gradient appr. %	λ_D W/(mK)	Unit of quantity UQ	€/UQ
Insulation system	2	0.022	m ³	upon request

LINITHERM PAL gradient

PH 21502010

Insulation core	PU rigid foam acc. to EN 13165, fire behavior class E acc. to EN 13501-1, coated with aluminum film on both sides, low-glare on one side
Edge joints	Round about edgeless cut
Overall dimension	1200 × 1200 mm

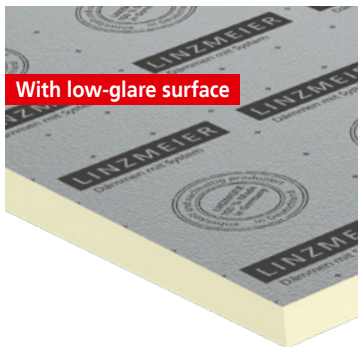

Thickness mm total	Gradient appr. %	Quantity per pallet Piece	m ²	λ_D W/(mK)	€/m ²
30/55	2	48	69.1	0.022	26.40
55/80	2	32	46.1	0.022	35.50
80/105	2	24	34.6	0.022	44.00
105/130	2	20	28.8	0.022	52.40
130/155	2	16	23.0	0.022	59.90
155/180	2	12	17.3	0.022	66.80
180/205	2	12	17.3	0.022	74.00
205/230	2	8	11.5	0.022	80.90

LINITHERM PAL gradient ridge board 45° angle

PH 21502010

Set consisting of ridge board left and ridge board right, low-glare on one side



Thickness mm total	Gradient appr. %	Quantity per pallet Sets	λ_D W/(mK)	€/Set
30/55	2	32	0.022	47.40
55/80	2	24	0.022	61.00
80/105	2	20	0.022	74.60
105/130	2	16	0.022	89.50
130/155	2	12	0.022	101.60
155/180	2	12	0.022	114.40
180/205	2	8	0.022	127.10
205/230	2	8	0.022	139.60

With low-glare surface

LINITHERM PAL gradient valley board 45° angle

PH 21502010

Set consisting of valley board left and valley board right, low-glare on one side

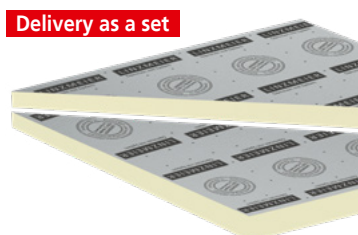

Thickness mm total	Gradient appr. %	Quantity per pallet Sets	λ_D W/(mK)	€/Set
30/55	2	32	0.022	47.40
55/80	2	24	0.022	61.00
80/105	2	20	0.022	74.60
105/130	2	16	0.022	89.50
130/155	2	12	0.022	101.60
155/180	2	12	0.022	114.40
180/205	2	8	0.022	127.10
205/230	2	8	0.022	139.60

Point drainage
with LINITHERM PAL/PGV gradient
and valley boards

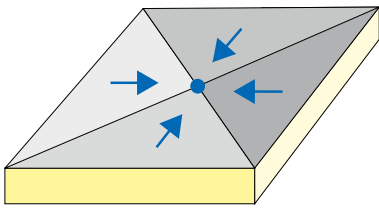

Interior drainage
with LINITHERM PAL/PGV gradient
and valley boards

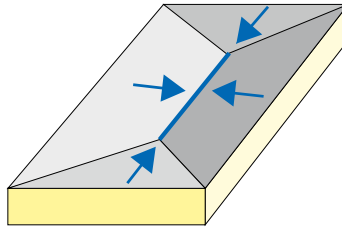

Outside drainage
with LINITHERM PAL/PGV gradient
and ridge boards

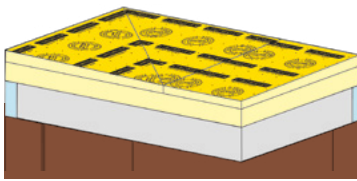
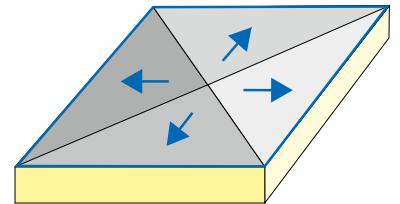

LINITHERM PGV gradient insulation for flat roofs

PH 21502020

Gradient insulation system, λ_D 0.026/0.028, consisting of basic insulation LINITHERM PGV, LINITHERM PGV gradient and LINITHERM PGV ridge/valley boards, according to gradient plan, description of the system components: see pages 24 and 27

	Gradient appr. %	λ_D W/(mK)	Unit of quantity UQ	€/UQ
Insulation system	2	0.026/0.028	m ³	upon request

LINITHERM PGV gradient

PH 21502020

Insulation core	PU rigid foam acc. to EN 13165, fire behavior class E acc. to EN 13501-1, thickness 5/30 mm unlaminated, other thicknesses coated with mineral fleece on both sides
Edge joints	Round about edgeless cut
Overall dimension	1200 × 1200 mm

Thickness mm total	Gradient appr. %	Quantity of pallet Piece		λ_D W/(mK)	€/m ²
5/30	2	116	167.0	0.028	20.50
30/55	2	48	69.1	0.028	24.00
55/80	2	32	46.1	0.028	32.80
80/105	2	24	34.6	0.026	41.20
105/130	2	20	28.8	0.026	49.40



LINITHERM PGV gradient ridge board 45° angle

PH 21502020

Set consisting of ridge board left and ridge board right, thickness 5/30 mm unlaminated

Thickness mm total	Gradient appr. %	Quantity of pallet Sets	λ_D W/(mK)	€/Set
5/30	2	38	0.028	34.60
30/55	2	32	0.028	40.60
55/80	2	24	0.028	53.40
80/105	2	20	0.026	66.60
105/130	2	16	0.026	81.10

Delivery as a set



LINITHERM PGV gradient valley board 45° angle

PH 21502020

Set consisting of valley board left and valley board right, thickness 5/30 mm unlaminated

Thickness mm total	Gradient appr. %	Quantity of pallet Sets	λ_D W/(mK)	€/Set
5/30	2	38	0.028	34.60
30/55	2	32	0.028	40.60
55/80	2	24	0.028	53.40
80/105	2	20	0.026	66.60
105/130	2	16	0.026	81.10

Delivery as a set



THERM PAL gradient / LINITHERM PGV gradient

PH 21502020

	€/Plan
Gradient plan < 200 m ²	80.00
Gradient plan > 200 m ²	110.00
Change	50.00

Flat roof insulation – ridge turret

Spot drainage with
LINITHERM ridge turret

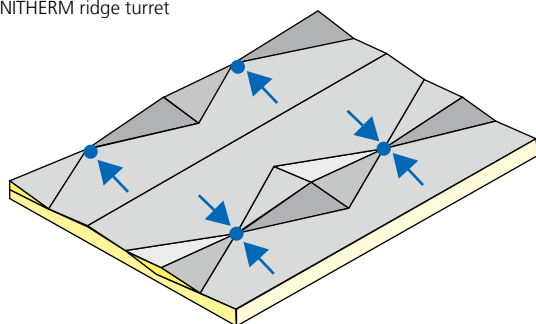

Gradient lengthwise: 1.25 %
Gradient transverse: 5.00 %
Resulting slope (area): 3.30 %

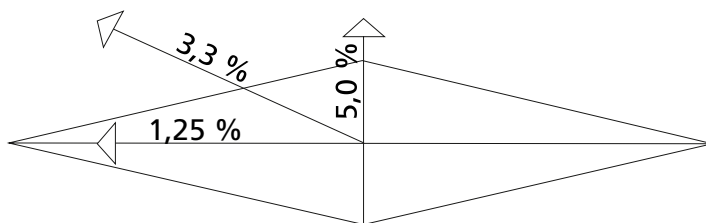

Flat roof

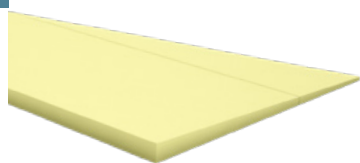

LINITHERM ridge turret

PH 21500020

Insulation core PU rigid foam acc. to EN 13165, fire behavior class E acc. to EN 13501-1, unlaminated
Edge joints Round about edgeless cut

Thickness mm total	Length mm	Width mm	λ_D W/(mK)	€/piece
Ridge turret DR1200	1200	300	0.027	118.80
Ridge turret DR2400	2400	600	0.027	151.40
Ridge turret DR3600	3600	900	0.027	190.60
Ridge turret DR4800	4800	1200	0.027	305.00
Ridge turret DR6000	6000	1500	0.027	457.60
Ridge turret DR7200	7200	1800	0.027	763.20
Ridge turret DR8400	8400	2100	0.027	1.018.30
Ridge turret DR9600	9600	2400	0.027	1.320.00
Ridge turret DR10800	10800	2700	0.027	1.448.60
Ridge turret DR12000	12000	3000	0.027	1.913.20
Ridge turret DR13200	13200	3300	0.027	2.500.20

LINITHERM counter gradient GG

PH 21500020

Insulation core PU rigid foam acc. to EN 13165, fire behavior class E acc. to EN 13501-1, unlaminated
Edge joints Round about edgeless cut

Thickness mm total	Length mm	Width mm	λ_D W/(mK)	€/piece
30/5	1200	600	0.027	24.60
50/5	1200	600	0.027	30.80



Single dimensions

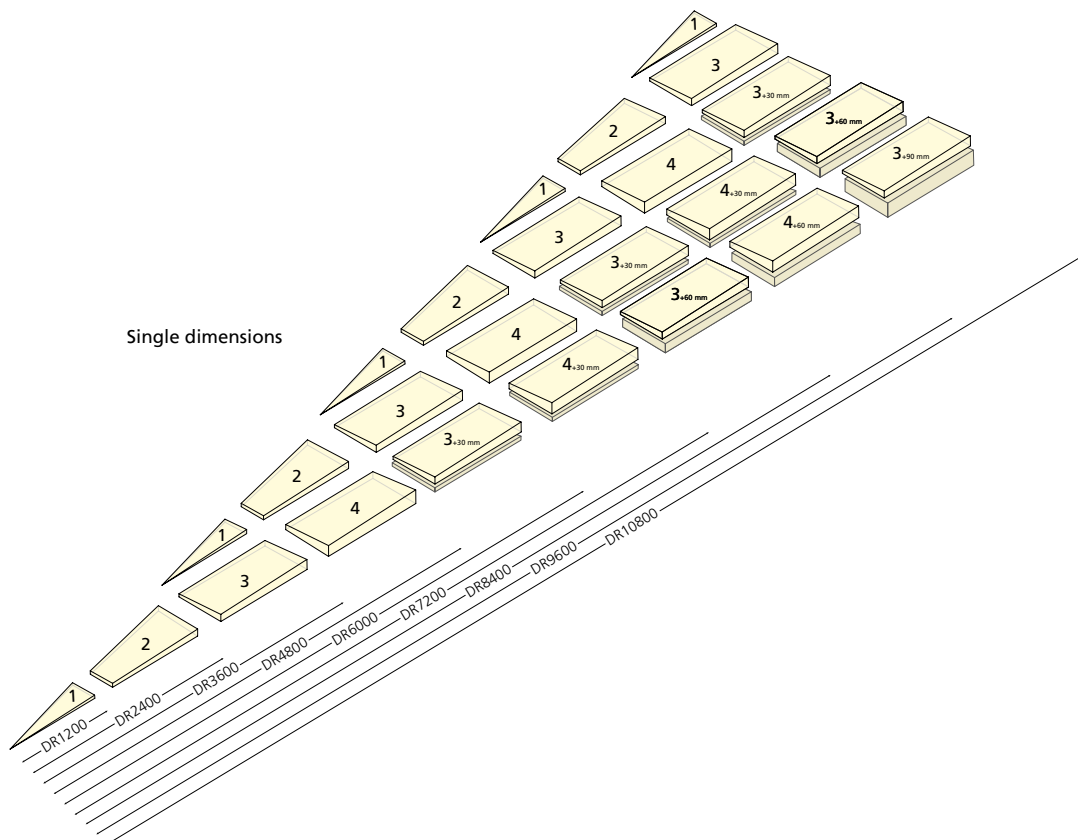

Terrace structure

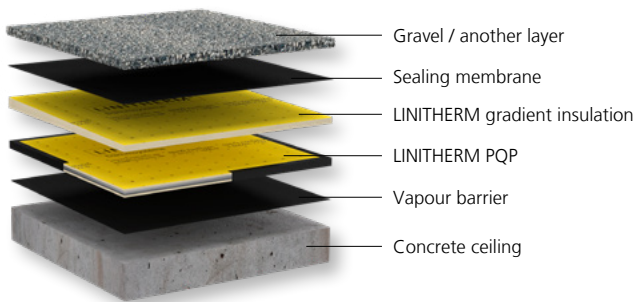

Advantages

- Ultrathin, most effective insulation of flat roof, balcony and terrace
- Connection heights can be adhered that are not possible with usual insulation material
- Optimal insulation system, for balconies and terraces if underlying living spaces should be protected
- Can be combined optimally according to requirements
- Allows a barrier-free transition between living spaces and terrace when carrying out renovation measures
- LINITHERM PGV cover layer on both sides protects the vacuum insulation core against mechanical damage

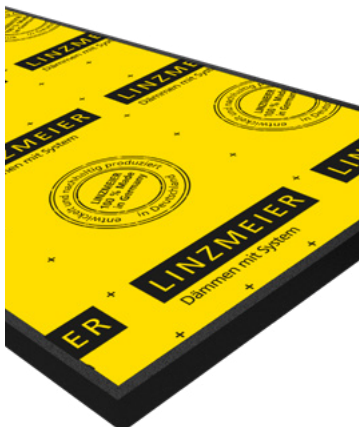

LINITHERM PQP

PH 21500030

Insulation core	20 mm vacuum insulation, fire behavior class E acc. to EN 13501-1
Outer layers	10 mm PU rigid foam acc. to EN 13165 on each side, fire behavior class E acc. to EN 13501-1, coated with mineral fleece on both sides
Edge joints	Round about edgeless cut, covered with tape

Thickness mm total	Thickness mm vacuum element	Measurement mm	λ_D PU	λ_D vacuum	U-value* [W/(m ² K)]	€/m ²
40	20	1200 × 600	0.028	0.0066	0.27	227.30
40	20	1200 × 300	0.028	0.0066	0.27	244.30
40	20	600 × 300	0.028	0.0066	0.27	268.80
40	20	600 × 150	0.028	0.0066	0.27	299.60
60	40	1200 × 600	0.028	0.0066	0.15	318.90
60	40	1200 × 300	0.028	0.0066	0.15	341.50
60	40	600 × 300	0.028	0.0066	0.15	376.60
60	40	600 × 150	0.028	0.0066	0.15	419.50

Special dimension upon request.

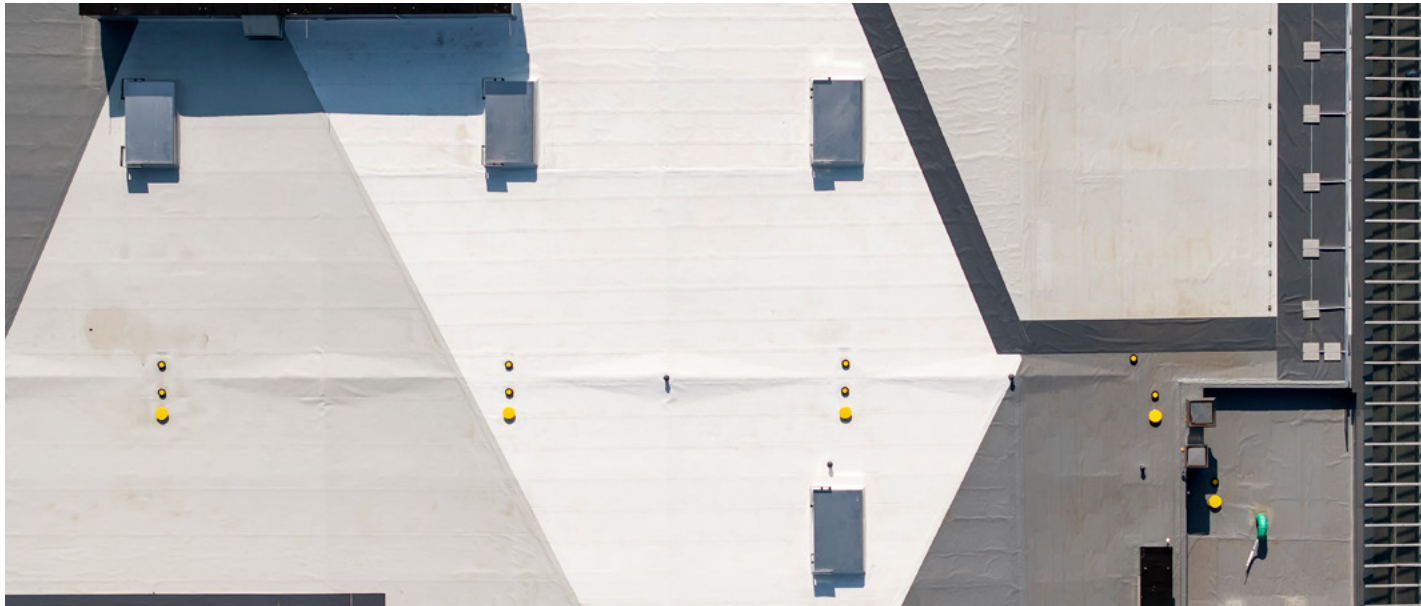

LITEC parapet element

PH 31

Insulation core	PU rigid foam acc. to EN 13165, thickness 60 mm, fire behavior class E acc. to EN 13501-1, with mineral fleece on both sides
Facing	Inside and outside: derived wood panel P5, 22 mm thick
Please note	Individual factory-made parts according to construction plan, incl. wooden construction elements

For details see page 48



* U-value calculation takes the thermal resistances $R_{si} = 0.1$ [m²K/W] and $R_{se} = 0.04$ [m²K/W] into account. Building-specific characteristics for example as per EN ISO 6946 are not taken into account.

External wall insulation from the outside – ventilated façades

LINITHERM External wall insulation from the outside for ventilated façade

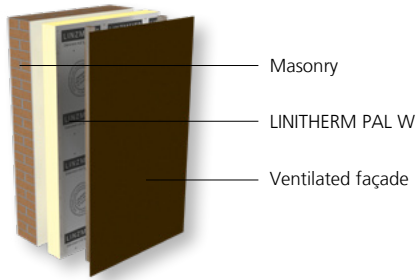

Benefits for builder and renovators

- Reliable insulation for ventilated façades and core insulation
- Maximum insulation values with minimum panel thickness
- Slim wall constructions possible
- Pressure-resistant and dimensionally stable
- Of low flammability - fire behaviour class C-s2, d0 acc. to EN 13501-1
- Installation without thermal bridges
- Easy handling through manageable dimensions and low weight

Flame resistant

LINITHERM PAL W

PH 21600070



Insulation core	PU rigid foam acc. to EN 13165, fire behavior class C-s2,d0 acc. to EN 13501-1 (corresponds to German building inspection class »of low flammability«), aluminum foil on both sides, low-glare on one side
Edge joints	Round about edgeless cut or with rebated joint
Overall dimension	1200 × 600 mm (= calculation measurement) (coverage with rebated joint is 2 cm smaller)

Thickness mm total	Quantity per package Piece	Quantity per package m ²	Quantity per pallet Piece	Quantity per pallet m ²	λ_D W/(mK)	U-value** [W/(m ² K)]	€/m ²
80	6	4.32	60	43.2	0.022	0.26	25.70
100	5	3.60	50	36.0	0.022	0.21	30.50
120	4	2.88	40	28.8	0.022	0.18	35.90
140	3	2.16	36	25.9	0.022	0.15	41.40
160	3	2.16	30	21.6	0.022	0.13	46.80
180*	2	1.44	28	20.2	0.022	0.12	52.20
200*	2	1.44	24	17.3	0.022	0.11	57.50
Additional price for rebated joint per m ² net							+ 0.30

Delivery only in full packages.



* Might have longer delivery times.
 ** U-value calculation takes the thermal resistances $R_{si} = 0.13$ [m²K/W] and $R_{se} = 0.04$ [m²K/W] into account. Building-specific characteristics for example as per EN ISO 6946 are not taken into account.

External wall insulation from the outside – core insulation

Core insulation in double-shell masonry walls

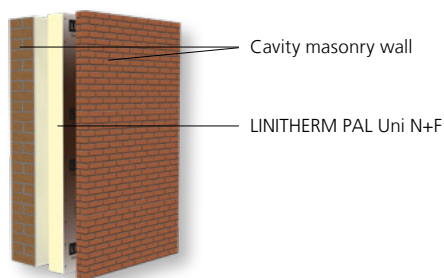

LINITHERM PAL Uni N+F

PH 21600080

Insulation core	PU rigid foam acc. to EN 13165, fire behavior class E n. EN 13501-1, coated with aluminum on both sides, low-glare on one side
Edge joints	Tongue & groove pressfit joints on all sides
Overall dimension	1200 × 600 mm (= calculation measurement) (coverage with tongue & groove is 2 cm smaller)

Thickness mm total	Quantity per package Piece	Quantity per package m ²	Quantity per pallet Piece	Quantity per pallet m ²	λ_D W/(mK)	U-value* [W/(m ² K)]	€/m ²
80	6	4.32	60	43.2	0.022	0.26	24.70
100	5	3.60	50	36.0	0.022	0.21	29.50
120	4	2.88	40	28.8	0.022	0.18	34.90
140	3	2.16	36	25.9	0.022	0.15	40.40
160	3	2.16	30	21.6	0.022	0.13	45.80
180*	2	1.44	28	20.2	0.022	0.12	51.20
200*	2	1.44	24	17.3	0.022	0.11	56.50

Delivery only in full packages.

DGNB Produkt gelistet im Navigator

External wall from outside



* Might have longer delivery times.

** U-value calculation takes the thermal resistances $R_{si} = 0.13$ [m²K/W] and $R_{se} = 0.04$ [m²K/W] into account. Building-specific characteristics for example as per EN ISO 6946 are not taken into account.

LINITHERM PAL GK with existing insulation between the rafters

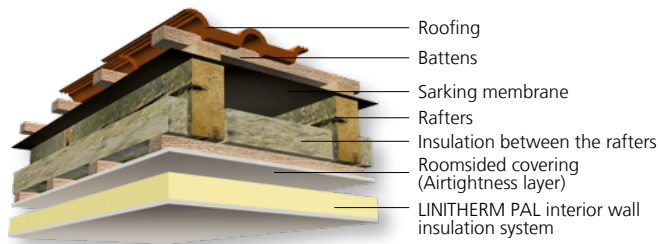

LINITHERM PAL GK in new construction with full rafter insulation

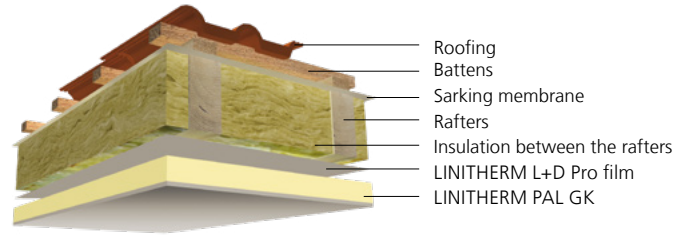

New format

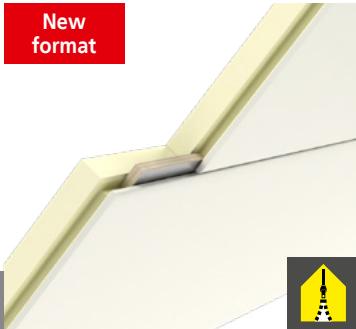

LINITHERM PAL GK

PH 21300020

Insulation core	PU rigid foam acc. to EN 13165, fire behaviour class E acc. to EN 13501-1, coated with aluminum film on both sides
Facing	Plasterboard facing on the inner side, 9.5 mm thick
Edge joints	Round about grooved for loose plywood spring (included in delivery)
Overall dimension	2400 × 600 mm (= calculation measurement)

Thickness mm total	Thickness mm PU	Thickness mm Plasterboard	Quantity per pallet Piece		λ_D W/(mK)	U-value* [W/(m²K)]	€/m²
39.5	30	9.5	45	64.8	0.022	0.65	49.30
49.5	40	9.5	36	51.8	0.022	0.50	53.60
69.5	60	9.5	26	37.4	0.022	0.34	63.40
89.5	80	9.5	20	28.8	0.022	0.26	72.70
109.5	100	9.5	17	24.5	0.022	0.21	82.60

LINIFIX screws Troko for PAL GK

PH 21309000

Quantity required Approx. 8 pieces per m²

Thickness mm element	Ø × Length mm	Size Content	Unit of quantity UQ	€/UQ
39.5 – 49.5	5.1 × 90	250 pieces/package	package	43.70
69.5	5.1 × 110	250 pieces/package	package	48.50
89.5	5.1 × 130	250 pieces/package	package	52.40
109.5	5.1 × 160	250 pieces/package	package	56.20

For direct installation to rafters.



* Thermal conductivity coefficient U takes the thermal resistance $R_{s1} = 0.1$ [m²K/W] and $R_{s2} = 0.04$ [m²K/W] into account. Object-specific characteristics according to EN ISO 6946 are not taken into account.

Accessories



LINITHERM 1K-PU-pistol foam PH 21009000

LINITHERM filling and sealing foam, incl. recycling fee

Consumption for approx. 10 mm joint width	Size Content	Quantity per package	Unit of quantity UQ	€/UQ
Approx. 10–12 lm	Can 750 ml	12 cans	piece	11.50

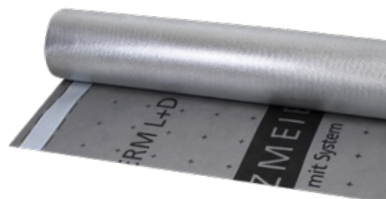

LINITHERM L+D Pro PH 21009030

PP-vapour barrier and airtightness membrane for roof, ceiling and wall constructions, Polypropylene nonwoven, aluminized polypropylene, fire behavior class E acc. to EN 13501-1, s_d-value 2 m, temperature resistance –30 °C to +80 °C, lengthwise overlapping on both sides with acrylate-adhesive tape

Width m	Length m	Size roll m ²	Quantity per package	Unit of quantity UQ	€/UQ
1.5	50	75	24 rolls	m ²	4.00



LINITHERM L+D adhesive tape PH 21009030

For LINITHERM L+D Pro

Width mm	Size roll lm	Quantity per package	Unit of quantity UQ	€/UQ
60	25	10 rolls	lm	2.20



LINITHERM Dichtfix PH 21009030

LINITHERM Dichtfix is a high performance adhesive binder, which permanently glues vapour barriers and vapour brakes with hard surfaces – without using a pressure lath. LINITHERM Dichtfix can be mixed with water for use as a primer

Size	Consumption with an 8 mm thick bead	Package Content	Unit of quantity UQ	€/UQ
Cartouche	310 ml	ca. 8 lm	12 cartouches	piece 11.20



LINITHERM compriband PH 21009030

For sealing the gap between masonry and insulation, compress to about 30% when installed impregnated, and one side self-adhesive

Original thickness x selfadhesive width mm	For joints up to mm	Pre-compressed delivery format mm	Size roll m	Quantity per package lm	Unit of quantity UQ	€/UQ
20 x 15	3–7	4 x 15	6.0	120.0	lm	3.50
40 x 20	7–12	8 x 20	5.0	75.0	lm	6.60
60 x 30	10–18	12 x 30	5.0	50.0	lm	12.50

External wall insulation from the inside

External wall insulation from the inside with LINITHERM PAL SIL

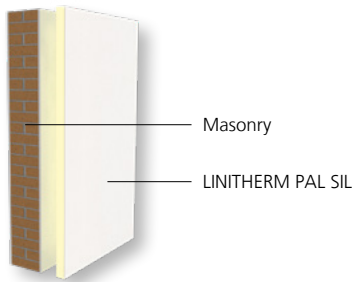

Benefits for builders and renovators

- Excellent insulation values
- Manageable, lightweight insulation elements
- Simple processing, free of thermal bridges
- Facing can be rendered, painted or wallpapered
- Additional living space due to slim construction
- Positive ecobalance
- Structural physical correct construction
- The silicate panel is resistant to moisture and mould

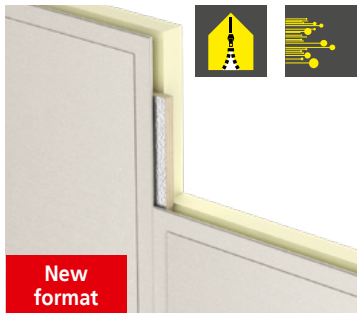

New format

LINITHERM PAL SIL

PH 21300070

Insulation core	PU rigid foam acc. to EN 13165, fire behavior class E acc. to EN 13501-1, coated with aluminum film on both sides
Facing	Silicate panel on room side, thickness 6 mm
Edge joints	Round about grooved for loose plywood spring (included in delivery) silicate panel with drywall edge
Overall dimension	2400 × 600 mm (= calculation measurement)

Thickness mm total	Thickness mm PU	Thickness mm silicate panel	Quantity per pallet		λ_D	U-value*	€/m ²
			Piece	m ²	W/(mK)	[W/(m ² K)]	
36	30	6	45	64.8	0.022	0.64	58.70
46	40	6	36	51.8	0.022	0.50	64.60
66	60	6	26	37.4	0.022	0.34	71.60

LINITHERM PAL SIL L for walls that will be tiled or under flat roofs

PH 21300070

Insulation core	PU rigid foam acc. to EN 13165, fire behavior class E acc. to EN 13501-1, coated with aluminum film on both sides
System	With integrated battens for mechanical fixation
Facing	Silicate panel on room side, thickness 6 mm, affixed to the integrated battens with clips
Edge joints	Round about grooved for loose plywood spring (included in delivery), silicate panel with drywall edge
Overall dimension	2400 × 600 mm (= calculation measurement)

Thickness mm total	Thickness mm PU	Thickness mm silicate panel	Quantity of pallet		λ_D	U-value*	€/m ²
			Piece	m ²	W/(mK)	[W/(m ² K)]	
46	40	6	36	51.8	0.022	0.55	72.70
66	60	6	26	37.4	0.022	0.37	81.40



New format

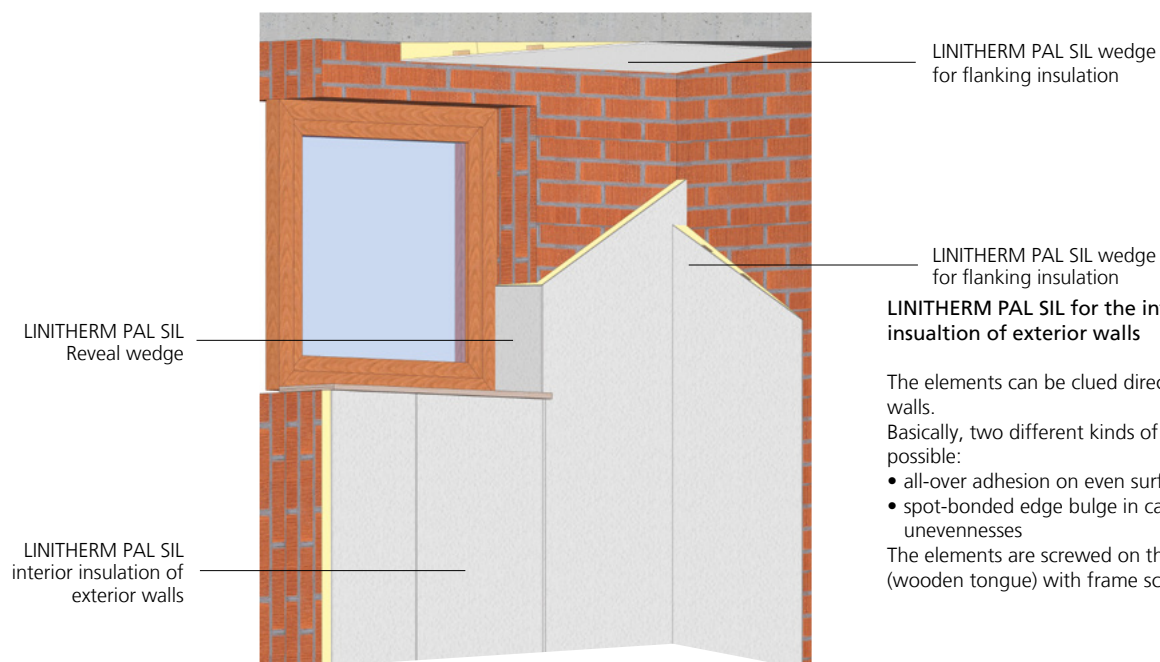

LINITHERM PAL SIL wedge for flanking insulation

LINITHERM PAL SIL wedge for flanking insulation

LINITHERM PAL SIL for the interior insulation of exterior walls

The elements can be glued directly on the walls.

Basically, two different kinds of gluing are possible:

- all-over adhesion on even surfaces
- spot-bonded edge bulge in case of unevenness

The elements are screwed on the long side (wooden tongue) with frame screws.

* U-value calculation takes the thermal resistances $R_{s,i} = 0.13$ [m²K/W] and $R_{s,e} = 0.04$ [m²K/W] into account. Building-specific characteristics for example as per EN ISO 6946 are not taken into account.



LINITHERM PAL SIL wedge flanking insulation PH 21300070

Insulation core	PU rigid foam acc. to EN 13165, fire behavior class E acc. to EN 13501-1
System	With integrated battens for mechanical fixation
Facing	Silicate panel on room side, thickness 6 mm, affixed to the integrated battens with clips
Edge joints	Round about edgeless cut
Overall dimension	2400 × 600 mm (= calculation measurement)

Thickness mm total	Thickness mm PU	Thickness mm silicate panel	λ_D W/(mK)	Unit of quantity UQ	€/UQ
66/6	60/0	6	0.028	lm	37.30



LINITHERM PAL SIL reveal wedge PH 21300070

Insulation core	PU rigid foam acc. to EN 13165, fire behavior class E acc. to EN 13501-1
Facing	Silicate panel on room side, thickness 6 mm
Edge joints	Round about edgeless cut
Overall dimension	2400 × 300 mm (= calculation measurement)

Thickness mm total	Thickness mm PU	Thickness mm silicate panel	λ_D W/(mK)	Unit of quantity UQ	€/UQ
26/14	20/8	6	0.028	lm	22.70



LINITHERM PAL SIL cutting board PH 21309000

Insulation core	PU rigid foam acc. to EN 13165, fire behavior class E acc. to EN 13501-1, coated with aluminum film on both sides
Facing	Silicate panel on room side, thickness 6 mm
Edge joints	Untrimmed
Overall dimension	2400 × 1200 mm (= calculation measurement), reveal board without edge connection

Thickness mm total	Thickness mm PU	Thickness mm silicate panel	Quantity of pallet Piece	λ_D W/(mK)	U-value* [W/(m²K)]	€/m²
26	20	6	45	129.6	0.91	43.60

External wall from inside

Accessories

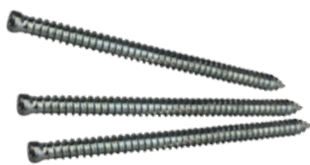

LINIFIX frame screw PH 21309000

Penetration depth	30–60 mm depending on the masonry
Quantity required	Approx. 2 pieces per m²

	Ø × Length mm	Size Content	Unit of quantity UQ	€/UQ
	7.5 × 72	100 pieces/packages	package	46.70
	7.5 × 82	100 pieces/packages	package	51.30
	7.5 × 92	100 pieces/packages	package	57.00
	7.5 × 102	100 pieces/packages	package	61.60
	7.5 × 122	100 pieces/packages	package	77.30



Glue PH 21309000

	Gluing mortar, universally applicable for interior use, very good adherence
Quantity required	Approx. 3.5 kg/m²

	Size Content	Unit of quantity UQ	€/UQ
	20 kg	bag	43.10

External wall insulation from the inside

External wall insulation from the inside with LINITHERM PAL UK

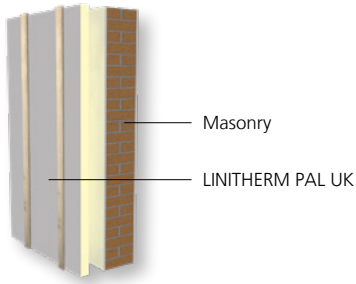

Benefits for builders and renovators

- Minimum construction height
- 2 in 1 - insulation with integrated 24 mm battens
- Intermediate space can be used as an installation level
- Time saving, faster installation thanks to integrated battens
- Full-surface insulation made of highly thermally insulating PU rigid foam
- Free choice of interior panelling plate (not included in delivery)
- Install electrical fixtures (LED spotlights, sockets) easily, quickly, flexibly and safely or, if necessary, retrofit them without damaging the air density level

LINITHERM PAL UK

PH 21300080

Insulation core	PU rigid foam acc. to EN 13165, fire behavior class E acc. to EN 13501-1, coated with aluminum film on both sides
Battens	Longitudinal battens 2 × made of wood-based panel 24/50 mm, centre-to-centre distance 290 mm
Edge joints	Round about rebated joint
Overall dimension	2400 × 600 mm (= calculation measurement) (coverage with rebated joint is 2 cm smaller)

Thickness mm total	Thickness mm PU	Thickness mm battens	Quantity per pallet Piece	λ_D W/(mK)	U-value* [W/(m ² K)]	€/m ²	
84	60	24	24	34.6	0.022	0.34	37.70
104	80	24	20	28.8	0.022	0.26	42.20
124	100	24	16	23.0	0.022	0.21	46.70

New format

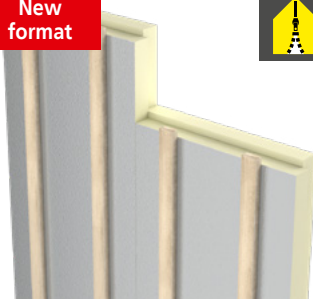

The LINITHERM PAL UK insulation element is the universal interior insulation. It can be fitted to the rafters, the ceiling or the wall.

Thanks to the laminated battens, the substructure for the room-side panelling is supplied at the same time, which significantly reduces the installation time. The 24 mm deep intermediate space is ideal for use as an installation level.

When installing on a solid wall or ceiling, the product is fixed directly to the wall or ceiling with screws through the support battens. Additional bonding with adhesive mortar or adhesive foam is recommended to prevent air flow behind the product.

Basically, two types of adhesive can be used here:

- Full-surface bonding with a level substrate
- Edge bead point bonding for uneven surfaces

The insulation board is also attached to the rafters using the laminated battens. An airtight layer should be present or created using our LINITHERM L+D Pro membrane for installation on the rafters.

The joints can also be taped if higher tightness requirements apply.



* U-value calculation takes the thermal resistances $R_{s,i} = 0.13$ [m²K/W] and $R_{s,e} = 0.04$ [m²K/W] into account. Building-specific characteristics for example as per EN ISO 6946 are not taken into account.

Accessories



LINITHERM 1K-PU-pistol foam PH 21009000

LINITHERM filling and sealing foam, incl. recycling fee

Consumption for approx. 10 mm joint width	Size Content	Quantity per package	Unit of quantity UQ	€/UQ
Approx. 10–12 lm	Can 750 ml	12 cans	piece	11.50



LINITHERM L+D Pro PH 21009030

PP-vapour barrier and airtightness membrane for roof, ceiling and wall constructions, Polypropylene nonwoven, aluminized polypropylene, fire behavior class E acc. to EN 13501-1, s_d-value 2 m, temperature resistance –30 °C to +80 °C, lengthwise overlapping on both sides with acrylate-adhesive tape

Width m	Length m	Size roll m ²	Quantity per package	Unit of quantity UQ	€/UQ
1.5	50	75	24 rolls	m ²	4.00

NEW



LINITHERM L+D adhesive tape PH 21009030

For LINITHERM L+D Pro

Width mm	Size roll lm	Quantity per package	Unit of quantity UQ	€/UQ
60	25	10 rolls	lm	2.20



LINITHERM Dichtfix PH 21009030

LINITHERM Dichtfix is a high performance adhesive binder, which permanently glues vapour barriers and vapour brakes with hard surfaces – without using a pressure lath. LINITHERM Dichtfix can be mixed with water for use as a primer

Size	Consumption with an 8 mm thick bead	Package Content	Unit of quantity UQ	€/UQ
Cartouche	310 ml	ca. 8 lm	12 cartouches	11.20



LINITHERM compriband PH 21009030

For sealing the gap between masonry and insulation, compress to about 30% when installed impregnated, and one side self-adhesive

Original thickness × selfadhesive width mm	For joints up to mm	Pre-compressed delivery format mm	Size roll m	Quantity per package lm	Unit of quantity UQ	€/UQ
20 × 15	3–7	4 × 15	6.0	120.0	lm	3.50
40 × 20	7–12	8 × 20	5.0	75.0	lm	6.50
60 × 30	10–18	12 × 30	5.0	50.0	lm	12.50

Insulation systems for floors / Accessories

Thermal insulation below screed without floor heating

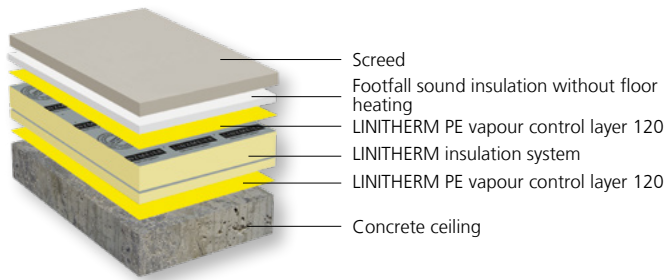

Thermal insulation below screed with floor heating

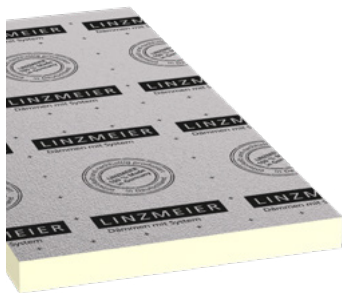
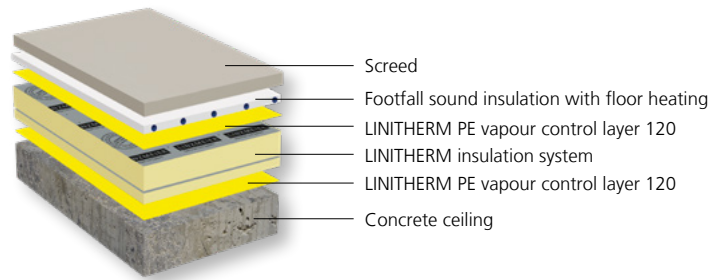

LINITHERM PMV

PH 21400030

Insulation core	PU rigid foam acc. to EN 13165, fire behavior class E acc. to EN 13501-1, coated with multi-layered composite foil on both sides
Edge joints	Round about edgeless cut
Overall dimension	1200 × 600 mm (= calculation measurement)

Thickness mm total	Quantity per package Piece	Quantity per package m ²	Quantity per pallet Piece	Quantity per pallet m ²	λ_D W/(mK)	U-value* [W/(m ² K)]	€/m ²
20	25	18.00	250	180.0	0.022	0.83	11.50
30	16	11.52	160	115.2	0.022	0.61	13.60
40	12	8.64	120	86.4	0.022	0.48	15.60
50	10	7.20	100	72.0	0.022	0.40	17.80
60	8	5.76	80	57.6	0.022	0.34	20.60
70	7	5.04	70	50.4	0.022	0.30	22.80
80	6	4.32	60	43.2	0.022	0.25	24.00

Delivery only in full packages.



* U-value calculation takes the thermal resistances $R_{si} = 0.17$ [m²K/W] and $R_{se} = 0.17$ [m²K/W] into account. Building-specific characteristics for example as per EN ISO 6946 are not taken into account.

Insulation on concrete attic floor that can be walked on and loaded

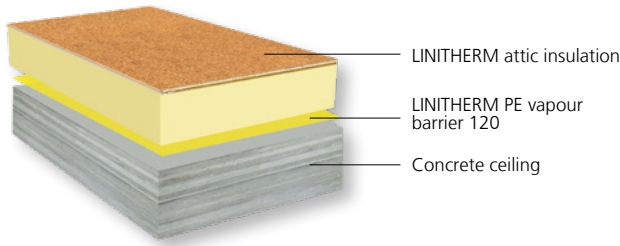

Insulation on concrete attic floor that can be walked on and loaded

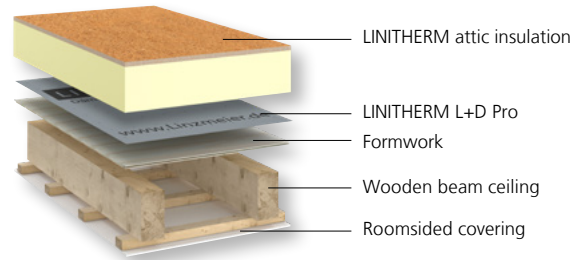

LINITHERM PHW PH 21201040

Insulation core	PU rigid foam acc. to EN 13165, fire behavior class E acc. to EN 13501-1, coated with aluminum film on both sides
Facing	Derived wood panel P5, thickness 10 mm
Edge joints	PU rigid foam serrated on all sides, derived wood panel round about with rebated joint
Overall dimension	1200 x 600 mm (= calculation measurement) (coverage is 1 cm smaller)

Thickness mm total	Thickness mm PU	Thickness mm P5 panel	Quantity of package Piece	Quantity of pallet m ²	Quantity of pallet Piece	PU λ _D W/(mK)	U-value* [W/(m ² K)]	€/m ²	
90	80	10	3	2.16	48	34.6	0.022	0.26	47.40
110	100	10	3	2.16	42	30.2	0.022	0.21	53.30
130	120	10	3	2.16	36	25.9	0.022	0.18	59.00
150	140	10	2	1.44	32	23.0	0.022	0.15	64.60
170	160	10	2	1.44	28	20.2	0.022	0.13	70.30

Other thicknesses upon request/Delivery only in full packages.

Accessories



Wood glue PH 21209000

Quantity required Approx. 40 g/m²

	Size Content	Unit of quantity UQ	€/UQ
Bottle	550 g	piece	17.30
Bucket	10 kg	piece	133.20



LINITHERM PE vapour control layer 120 PH 21209000

PE vapour control layer according to EN 13984, suitable for new buildings and restoration, s_d-value 120 m ±10, fire resistant, fire class E, weight 150 g/m² ±10, colour yellow

Width/m	Length/m	Size/Roll m ²	Unit of quantity/UQ	€/UQ
4	25	100	m ²	1.40



LINITHERM L+D adhesive tape PH 21009030

For LINITHERM L+D Pro and LINITHERM LOOP L+D

	Width mm	Size roll	Quantity per package	Unit of quantity UQ	€/UQ
	60	25	10 rolls	lm	2.20



LINITHERM Dichtfix PH 21009030

LINITHERM Dichtfix is a high performance adhesive binder, which permanently glues vapour barriers and vapour brakes with hard surfaces – without using a pressure lath. LINITHERM Dichtfix can be mixed with water for use as a primer

	Size	Consumption with an 8 mm thick bead	Package Content	Unit of quantity UQ	€/UQ
Cartouche	310 ml	approx. 8 lm	12 cartouches	piece	11.20



Edge insulation strips PH 21209000

PE-Edge insulation strips, white, self-adhesive (adhesive surface max. 150 mm)

	Thickness mm	Height mm	Packaging unit	Unit of quantity UQ	€/UQ
	8	110	1 roll à 25 m	lm	0.90
	8	150	1 roll à 25 m	lm	1.10
	8	190	1 roll à 25 m	lm	1.20

* U-value calculation takes the thermal resistances R_s = 0.1 [m²K/W] and R_{se} = 0.04 [m²K/W] into account. Building-specific characteristics for example as per EN ISO 6946 are not taken into account.

Insulation system for underground garages

insulation of underground garages
under concrete ceiling

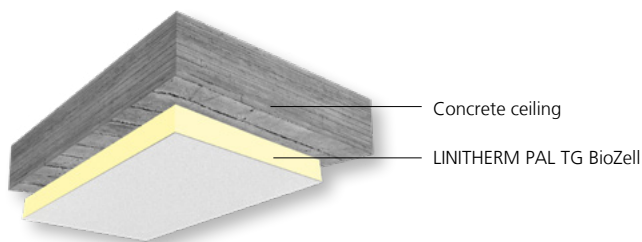

Flame resistant



LINITHERM PAL TG BioZell

PH 21102010

Insulation core	PU rigid foam acc. to EN 13165, fire behavior class C-s2 acc. to EN 13501-1, coated with aluminium foil on both sides				
Facing	Visible side = ecological fine plaster on a mineral base, thickness approx. 2 mm				
Edge joints	Tongue & groove joints on all sides				
Overall dimension	1200 x 600 mm (= calculation measurement) (coverage with tongue & groove is 2 cm smaller)				

Thickness mm PU	Quantity per pallet		λ_D W/(mK)	U-value* [W/(m ² K)]	€/m ²
	Piece	m ²			
60	64	64.1	0.022	0.33	50.80
80	48	34.6	0.022	0.25	56.30
100	38	27.4	0.022	0.21	61.80
120	32	23.0	0.022	0.17	67.30
160	24	17.3	0.022	0.13	78.00



LINITHERM PAL TG BioZell is classified as a flame-resistant insulation material according to DIN EN 13501-1 and is suitable for use in medium-sized garages according to M-GarVO (>100 m² to 1.000 m²). The regulations of the state building code or the locally applicable building regulations must be observed.



Ceiling

* U-value calculation takes the thermal resistances $R_{si} = 0.17$ [m²K/W] and $R_{se} = 0.17$ [m²K/W] into account. Building-specific characteristics for example as per EN ISO 6946 are not taken into account.



Surface structure of LINITHERM PAL TG BioZell

Accessories



LINIFIX fixation claw PH 21109010

Application	1-sided fixation claw				
	Length mm	Quantity required per element	Size Content	Unit of quantity UQ	€/UQ
galvanized	15 mm for thickness 60/80 mm 20 mm for thickness 100/120/160 mm	2 pieces	100 pieces	package	78.30



LINIFIX edge fixation clamps PH 21109010

Application	1-sided edge fixation clamp, length 25 mm				
	Length mm	Quantity required per element	Size Content	Unit of quantity UQ	€/UQ
galvanized	25 mm	2 pieces	25 pieces	package	26.50

Other fixation alternatives upon request.



Adhesive foam PH 21509020

Moisture-hardening single-component adhesive on a polyurethane basis for the gluing of insulation boards for flat roofs and gradient roofs, can be applied from -5°C ambient temperature or $+5^{\circ}\text{C}$ can temperature, flexible and not embrittling

	Size/Content	Scope per can	Quantity per package	Unit of quantity/UQ	€/UQ
Adhesive foam	850 ml	approx. 10–14 m ²	12 cans	piece	19.80



Repair kit PH 21109010

Ecological fine plaster, for covering cutting edges and repairing skips

Quantity required	Approx. 0.5 kg/m ²			
	Size Content	Unit of quantity UQ	€/UQ	
	5 kg	bucket	56.20	



Paint roller PH 21109010

Application For the application of the repair kit, width 12 cm, pile height approx. 11 mm

	Unit of quantity UQ	€/UQ
	piece	7.60

Insulation systems for cellar ceilings – ecological surface coating

Insulation of cellar ceiling under concrete ceiling

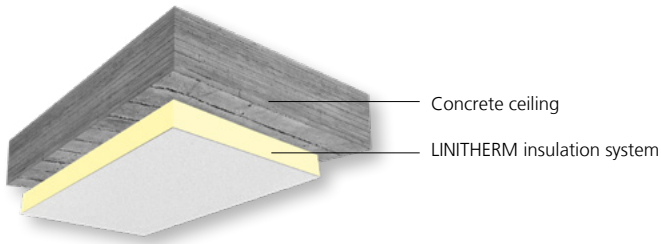

Flame resistant

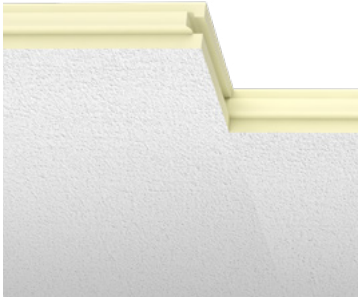

LINITHERM PAL KD BioZell

PH 21101040

Insulation core	PU rigid foam acc. to EN 13165, fire behavior class C-s2 acc. to EN 13501-1, coated with aluminium foil on both sides		
Facing	Visible side = ecological fine plaster on a mineral base, thickness approx. 2 mm		
Edge joints	Tongue & groove joints on all sides		
Overall dimension	1200 x 600 mm (= calculation measurement) (coverage with tongue & groove is 2 cm smaller)		

Thickness mm PU	Quantity per package Piece	Quantity per package m ²	Quantity per pallet Piece	Quantity per pallet m ²	λ_D W/(mK)	U-value* [W/(m ² K)]	€/m ²
60	8	5.76	80	57.6	0.022	0.33	50.80
80	6	4.32	60	43.2	0.022	0.25	56.30
100	5	3.60	50	36.0	0.022	0.20	61.80
120	4	2.88	32	23.0	0.022	0.17	67.30

Delivery only in full packages.



Produkt gelistet im
DGNB Navigator



Ceiling

* U-value calculation takes the thermal resistances $R_{si} = 0.17$ [m²K/W] and $R_{se} = 0.17$ [m²K/W] into account. Building-specific characteristics for example as per EN ISO 6946 are not taken into account.



Surface structure of LINITHERM PAL KD BioZell

Accessories

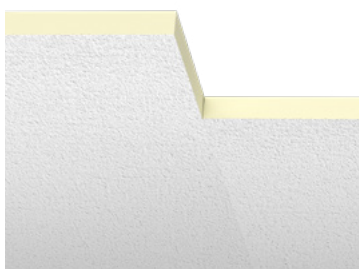

For insulation under heating pipes.



LINITHERM PAL KD BioZell cutting board PH 21109010

Insulation core	PU rigid foam acc. to EN 13165, fire behavior class E acc. to EN 13501-1, coated with aluminium foil on both sides
Facing	Visible side = ecological fine plaster on a mineral base, thickness approx. 2 mm
Edge joints	Round about edgeless cut
Overall dimension	1200 x 600 mm

Thickness mm	Quantity per package	λ_D	U-value*	€/m ²	
PU	Piece	W/(mK)	[W/(m ² K)]		
20	5	3.60	0.022	0.83	44.20

Delivery only in full packages.

LINIFIX fixation claw PH 21109010

Application	1-sided fixation claw
-------------	-----------------------

	Length mm	Quantity required per element	Size Content	Unit of quantity UQ	€/UQ
galvanized	15 mm for thickness 60/80 mm 20 mm for thickness 100/120 mm	2 pieces	100 pieces	package	78.30

LINIFIX edge fixation clamps PH 21109010

Application	1-sided edge fixation clamp, length 25 mm
-------------	---

	Length mm	Quantity required per element	Size Content	Unit of quantity UQ	€/UQ
galvanized	25 mm	2 pieces	25 pieces	package	26.50

Other fixation alternatives upon request.

Adhesive foam PH 21509020

	Moisture-hardening single-component adhesive on a polyurethane basis for the gluing of insulation boards for flat roofs and gradient roofs, can be applied from -5 °C ambient temperature or +5 °C can temperature, flexible and not embrittling				
--	--	--	--	--	--

	Size/Content	Scope per can	Quantity per package	Unit of quantity/UQ	€/UQ
Adhesive foam	850 ml	approx. 10–14 m ²	12 cans	piece	19.80

Repair kit PH 21109010

	Ecological fine plaster, for covering cutting edges and repairing skips				
Quantity required	Approx. 0.5 kg/m ²				

	Size Content	Unit of quantity UQ	€/UQ
	5 kg	bucket	56.20

Paint roller PH 21109010

Application	For the application of the repair kit, width 12 cm, pile height approx. 11 mm				
-------------	---	--	--	--	--

	Unit of quantity UQ	€/UQ
	piece	7.60

* U-value calculation takes the thermal resistances $R_{si} = 0.17$ [m²K/W] and $R_{se} = 0.17$ [m²K/W] into account. Building-specific characteristics for example as per EN ISO 6946 are not taken into account.

Insulation systems for cellar ceilings

Insulation of cellar ceiling under concrete ceiling

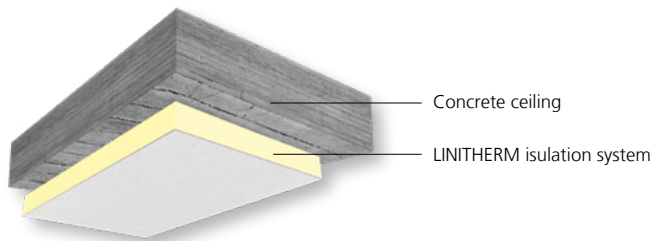

LINITHERM PAL KD N+F

PH 21101010

Insulation core	PU rigid foam acc. to EN 13165, coated with silver aluminum film on both sides Thickness 40–60 mm: fire behavior class E acc. to EN 13501-1 Thickness 80–120 mm: fire behavior class C-s2,d0 acc. to EN 13501-1
Edge joints	Tongue & groove joints on all sides
Overall dimension	1200 × 600 mm (= calculation measurement) (coverage with tongue & groove is 2 cm smaller)

Thickness mm	Quantity per package		Quantity per pallet		λ_D	U-value*	€/m ²
PU	Piece	m ²	Piece	m ²	W/(mK)	[W/(m ² K)]	
60	8	5.76	80	57.6	0.022	0.33	32.50
80	6	4.32	60	43.2	0.022	0.25	40.70
100	5	3.60	50	36.0	0.022	0.20	48.70
120	4	2.88	40	28.8	0.022	0.17	56.50

Other thicknesses upon request. Delivery only in full packages.



* U-value calculation takes the thermal resistances $R_{si} = 0.17$ [m²K/W] and $R_{se} = 0.17$ [m²K/W] into account. Building-specific characteristics for example as per EN ISO 6946 are not taken into account.

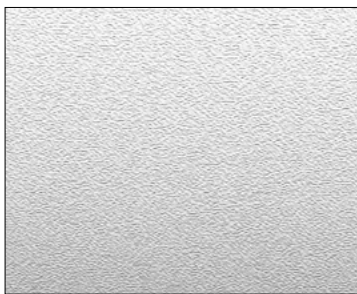

Surface structure of LINITHERM PAL KD

Accessories

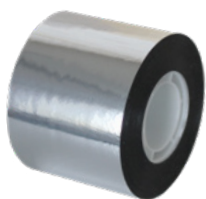

Adhesive tape PP

PH 21109010

Application PP-adhesive tape, for masking / covering the panel joints

Quantity required m ²	Size mm	Content roll	Unit of quantity UQ	€/UQ
2,5 lm	50	50 lfm	lm	0.70

LINIFIX fixation claw

PH 21109010

Application 1-sided fixation claw



Length mm	Quantity required per element	Size Content	Unit of quantity UQ	€/UQ
15 mm for thickness 60/80 mm 20 mm for thickness 100/120 mm	2 pieces	100 pieces	package	78.30

LINIFIX edge fixation clamps

PH 21109010

Application 1-sided edge fixation clamp, length 25 mm



Length mm	Quantity required per element	Size Content	Unit of quantity UQ	€/UQ
25 mm	2 pieces	25 pieces	package	26.50

Other fixation alternatives upon request.

L-wall connection profile

PH 21109010



Measurement mm	Length mm	Unit of quantity UQ	€/UQ
PVC grey-white 30/30	2400	lm	3.90
PVC grey-white 30/30	6000	lm	3.90

* U-value calculation takes the thermal resistances $R_{si} = 0.1$ [m²K/W] and $R_{se} = 0.04$ [m²K/W] into account. Building-specific characteristics for example as per EN ISO 6946 are not taken into account.

triangle dormer



gabled dormer



flat roof / shed dormer



hipped dormer



barrel dormer



flat roof dormer



LITEC GBS dormer building system kit

PH 31

Insulation core	PU rigid foam acc. to EN 13165, fire behavior class E acc. to EN 13501-1, with mineral fleece on both sides
Facing	Inside and outside: derived wood panel P5, thickness 22 mm
Please note	Individual factory-made parts according to construction plan, incl. wooden construction elements

Panel thickness mm €/building kit

144, 164, 184, 204	Price upon request
Dormer building kit	Invoicing at cost
Additional static calculations	

LITEC GBS M Price upon request
 Also available with integrated soundproofing panel, thickness 40 mm for improved soundproofing properties
 panel thicknesses 164 (80 + 40), 184 (100 + 40), 204 (120 + 40) mm

LITEC GS dormer renovation board

PH 31

Insulation core	PU rigid foam acc. to EN 13165, fire behavior class E acc. to EN 13501-1, with aluminum foil on both sides
Facing	Outside: derived wood panel P5, thickness 22 mm
Format	2440 × 1200 mm

Thickness mm total	Thickness mm PU	Thickness mm derived wood panel	λ_D W/(mK)	U-value* [W/(m ² K)]	€/m ²
82	60	22	0.022	0.33	56.60
102	80	22	0.022	0.25	62.00
122	100	22	0.022	0.21	67.20
142	120	22	0.022	0.17	72.60
162	140	22	0.022	0.15	77.50

Also available in other pre-assembled dimension and thickness Price upon request
 Other thicknesses upon request.



* U-value calculation takes the thermal resistances $R_{i1} = 0.13$ [m²K/W] and $R_{se} = 0.04$ [m²K/W] into account. Building-specific characteristics for example as per EN ISO 6946 are not taken into account.

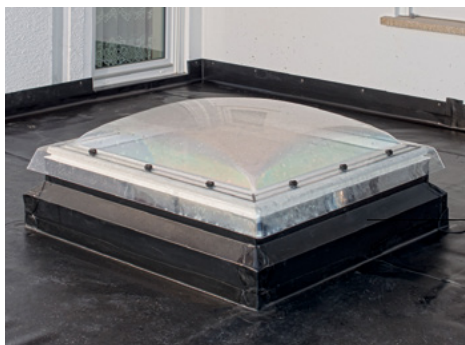

LITEC skylight base



LITEC attica element



LITEC VELUX skylight base for flat skylights

PH 31

Insulation core	PU rigid foam acc. to EN 13165, thickness 60 mm, fire behavior class E acc. to EN 13501-1, with mineral fleece on both sides
Facing	Inside and outside: derived wood panel P5, thickness 15 mm
Please note	Individual factory-made parts according to construction plan, incl. wooden construction elements
Scope of delivery	Pre-assembled component parts, 15 m compriband 20 x 15 mm, fixing material: 10 pcs 4.5 x 50 mm, 10 pcs 5 x 120 mm
Height	According to requirements

Other formats available upon request.

Price upon request

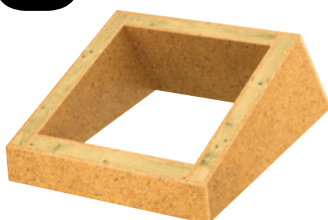

LITEC DAR skylight installation frame upon flat roofs

PH 31

Insulation core	PU rigid foam acc. to EN 13165, thickness 60 mm, fire behavior class E acc. to EN 13501-1, with mineral fleece on both sides
Facing	Inside and outside: derived wood panel P5, thickness 15 mm
Please note	Individual factory-made parts, incl. wooden construction element

Inner dimensions of flashing, width in mm		670	710	750	790	800	950	1000	1150	1200
VELUX	Window width mm	660			780		940		1140	
Roto WD/NE	Window width mm		650			740		940		1140
Roto	Window width mm	650		740			940		1140	
Kerb flashing		Window width mm		€/ Piece						
20°	VELUX	Roto WD/NE	Roto							
	980	1040	980	1.007.00	1.012.00					
	1180	1240	1180	1.049.00	1.056.00		1.075.00		1.126.00	
	1400	1460	1400	1.080.00	1.106.00		1.126.00		1.182.00	

Other formats or combinations available upon request for special window sizes.



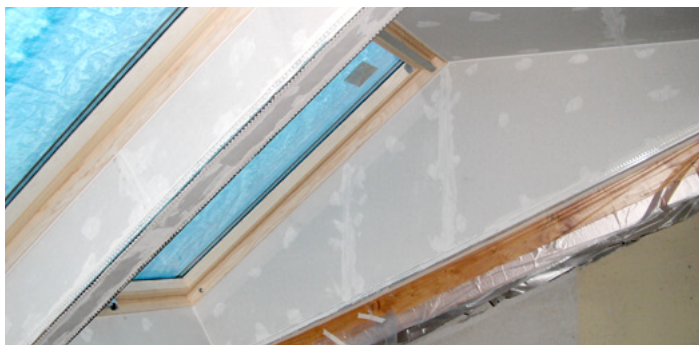

LITEC DAR skylight installation frame for pitched roofs

PH 31

Insulation core	PU rigid foam acc. to EN 13165, thickness 60 mm, fire behavior class E acc. to EN 13501-1, with mineral fleece on both sides
Facing	Inside and outside: derived wood panel P5, thickness 15 mm
Please note	Individual factory-made parts, incl. wooden construction element

Other formats for special window sizes or window-combinations available upon request.

Price upon request

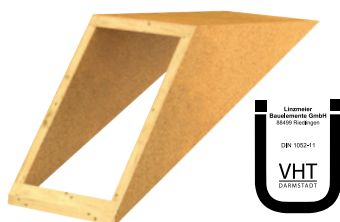

LITEC parapet element

PH 31

Insulation core	PU rigid foam acc. to EN 13165, thickness 60 mm, fire behavior class E acc. to EN 13501-1, with mineral fleece on both sides
Facing	Inside and outside: derived wood panel P5, thickness 15 mm
Please note	Individual factory-made parts according to construction plan, incl. wooden construction elements
Specification	Top cover 240 mm wide, loose. On request, lower sill loose for surface mounting.

Thickness mm total	Height mm	Length mm	Unit of quantity UQ	€/UQ
90	350	2500	1m	88.00
90	600	2500	1m	101.00
90	750	2500	1m	121.00

Other thicknesses upon request.

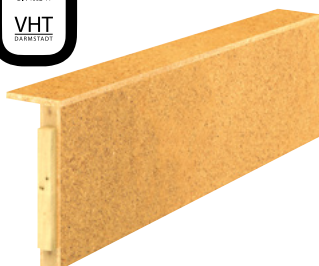

LITEC restoration bar



LITEC restoration bar Fix

PH 31



Insulation core	PU rigid foam acc. to EN 13165, fire behavior class E acc. to EN 13501-1, thickness 60 mm, coated with aluminum film on both sides
Facing	Outside three-layered spruce wood panel, thickness 22 mm
Please note	With solid structural timber (KVH) 1 × lengthwise and 1 × crosswise
Application	For over-insulating of the airtight connection at verge and eaves. The spruce triple-layer board can be painted, glazed, leaded or cladded with slate.

Thickness mm total	Thickness mm PU	Height mm	Lenght mm	Unit of quantity UQ	€/UQ
82	60	600	2500	lm m ²	98.00 163.33

LITEC restoration bar Standard

PH 31



Insulation core	PU rigid foam acc. to EN 13165, fire behavior class E acc. to EN 13501-1, thickness 60 mm, coated with aluminum film on both sides
Facing	Outside three-layered spruce wood panel, thickness 22 mm
Application	For over-insulating of the airtight connection at verge and eaves. The spruce triple-layer board can be painted, glazed, leaded or cladded with slate.

Thickness mm total	Thickness mm PU	Height mm	Lenght mm	Unit of quantity UQ	€/UQ
82	60	600	2500	lm	97.00

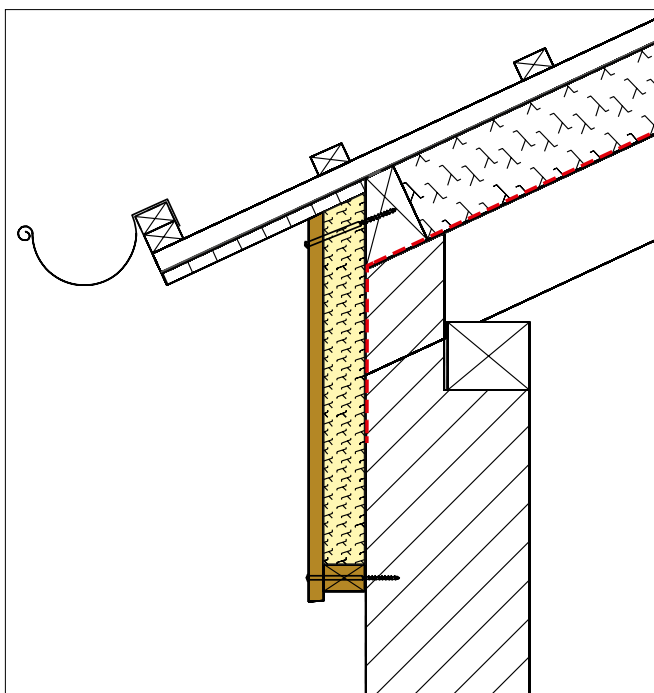

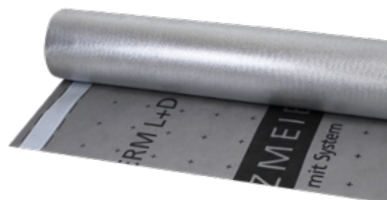

LINITHERM L+D Pro

PH 21009030

PP-vapour barrier and airtightness membrane for roof, ceiling and wall constructions, Polypropylene nonwoven, aluminized polypropylene, fire behavior class E acc. to EN 13501-1, s_d-value 2 m, temperature resistance – 30 °C to + 80 °C , lengthwise overlapping on both sides with acrylate-adhesive tape

Width m	Length m	Size roll m ²	Quantity per package	Unit of quantity UQ	€/UQ
1.5	50	75	24 rolls	m ²	4.00



LINITHERM L+D adhesive tape

PH 21009030

For LINITHERM L+D Pro

Width mm	Size roll	Quantity per package	Unit of quantity UQ	€/UQ
60	25	10 rolls	lm	2.20



LINITHERM Dichtfix

PH 21009030

LINITHERM Dichtfix is a high performance adhesive binder, which permanently glues vapour barriers and vapour brakes with hard surfaces – without using a pressure lath. LINITHERM Dichtfix can be mixed with water for use as a primer

Size	Consumption with an 8 mm thick bead	Package Content	Unit of quantity UQ	€/UQ	
Cartouche	310 ml	approx. 8 lm	12 cartouches	piece	11.20



Adhesive tape BK

PH 21009020

Application recommendation Butyl rubber, thickness 1 mm, for sealing coves, ridges, etc.

Width mm	Size roll m	Quantity per package	Unit of quantity UQ	€/UQ
200	10	5 rolls	lm	8.60
300	10	2 rolls	lm	14.60



T-Adhesive tape

PH 21009020

Application recommendation Polyacrylate adhesive tape

Width mm	Size roll m	Quantity per package	Unit of quantity UQ	€/UQ
200	25	4 rolls	lm	4.90



LINITHERM compriband

PH 21009030

For sealing the gap between masonry and insulation, compress to about 30% when installed impregnated, and one side self-adhesive

Original thickness x selfadhesive width mm	For joints up to mm	Pre-compressed delivery format mm	Size roll m	Quantity per package lm	Unit of quantity UQ	€/UQ
20 x 15	3–7	4 x 15	6.0	120.0	lm	3.50
40 x 20	7–12	8 x 20	5.0	75.0	lm	6.60
60 x 30	10–18	12 x 30	5.0	50.0	lm	12.50



LINITHERM 1K-PU-pistol foam

PH 21009000

LINITHERM filling and sealing foam, incl. recycling fee

Consumption for approx. 10 mm joint width	Size Content	Quantity per package	Unit of quantity UQ	€/UQ
Approx. 10–12 lm	Can 750 ml	12 cans	piece	11.50

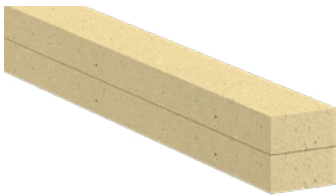
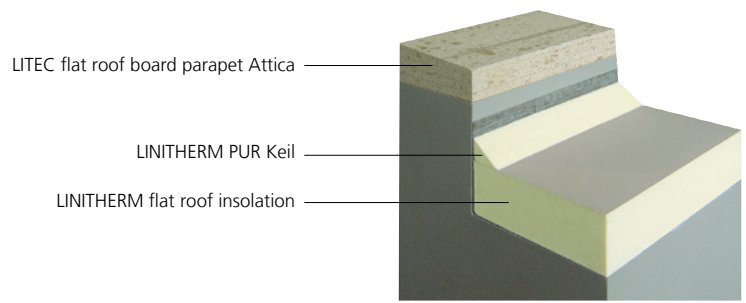

LITEC Flat roof board universal PH 31

Insulation core	Multiple glued layers of LINIREC construction boards, raw density approx. 550 kg/m ³ , class E acc. to EN 13501-1, can be used in temperature range of -50 °C to +100 °C, short-term peak temperature range of up to +250 °C							
Thermal conductivity	20–40 mm: λ_D 0.083 W/(mK); 50–60 mm: λ_D 0.085 W/(mK); 80–200 mm: λ_D 0.088 W/(mK)							
Width mm	50	100	125	175	240	360	425	490
Length mm	2440	2440	2440	2440	2440	2440	2440	2440
Thickness mm	€/lm							
20	4.60	8.30	10.70	14.20	20.30	30.00	32.90	38.20
30	6.20	12.20	14.30	20.80	27.70	42.10	49.60	57.40
40	8.20	15.80	20.30	27.50	37.90	56.60	66.00	76.30
50	10.20	19.60	25.00	34.30	47.60	71.00	82.60	95.30
60	12.20	22.90	29.50	40.80	55.90	83.20	99.50	114.40
80	15.50	31.60	38.90	54.50	74.50	112.00	132.50	152.30
100	19.60	38.90	48.80	68.20	93.40	139.90	165.00	190.70
120	23.80	47.60	58.40	81.40	112.00	168.00	198.10	228.70
140	27.00	54.50	68.20	95.30	130.70	196.10	231.40	267.10
160	31.20	62.30	77.90	108.80	149.40	223.80	264.50	304.90
180	34.70	70.40	87.70	122.50	168.00	252.10	297.80	343.10
200	38.90	77.90	97.20	136.60	186.40	280.30	330.50	381.00

Further dimensions and pre cut parts upon request.

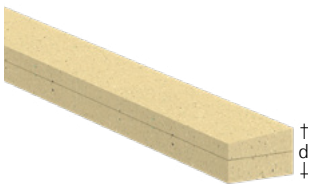

LITEC flat roof board parapet Attica PH 31

Insulation core	Multiple glued layers of LINIREC construction boards, raw density approx. 550 kg/m ³ , class E acc. to EN 13501-1, can be used in temperature range of -50 °C to +100 °C, short-term peak temperature range of up to +250 °C							
Thermal conductivity	20–40 mm: λ_D 0.083 W/(mK); 50–60 mm: λ_D 0.085 W/(mK); 80–100 mm: λ_D 0.088 W/(mK)							
Please note	Upper side bevelled with 5% inclination							
Width mm	50	100	125	175	240	360	425	490
Length mm	2440	2440	2440	2440	2440	2440	2440	2440
Thickness d mm	€/lm							
20	8.20	12.40	13.90					
30	9.70	15.40	18.60	24.10				
40	12.20	20.20	23.80	31.20	41.80			
50	13.60	23.80	29.20	38.40	50.80	74.50		
60	15.40	27.00	34.40	44.40	58.90	89.50	115.60	133.30
80	18.20	36.80	45.60	63.50	87.00	130.60	153.80	177.50
100	22.80	45.60	56.00	79.40	108.80	163.40	192.60	222.40

Further dimensions and pre cut parts upon request.



As door and window reveals



As filling of partition walls

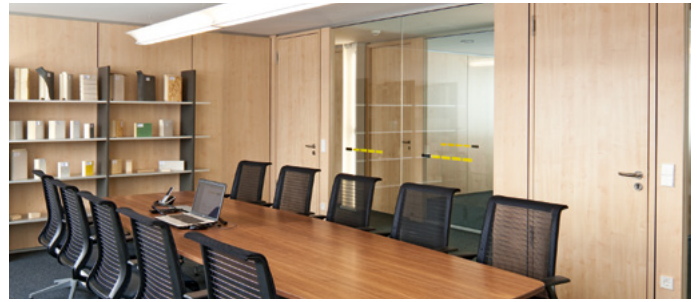

LINIREC construction board

PH 41

Insulation core	Made of recycled PU rigid foam, with European Technical evaluation (ETA 19/0193)*, raw density approx. 550 kg/m ³ , EN 1602, can be used in temperature range of -50 °C to +100 °C
Thermal conductivity	20–40 mm: λ_D 0.083 W/(mK); 50–80 mm: λ_D 0.085 W/(mK)
Compressive stress	≥ 7,1 MPa, EN 826 (fluctuations depending on the used flour / grain size, binder and binder mixture)
Thickness swelling	0.8 % according to EN 68763
Edges	Round about edgeless cut
Dimension	2440 × 1220 mm

Thickness mm PU	Quantity per pallet		λ_D W/(mK)	€/m ²
	Piece	m ²		
15*	40	119.1		47.20
20	30	89.3	0.083	54.00
25	24	71.4	0.083	62.40
30	20	59.5	0.083	73.30
40	15	44.7	0.083	91.40
50	12	35.7	0.085	114.60
60	10	29.8	0.085	137.20
80	7	20.8	0.085	182.50

Other thicknesses upon request

* Thicknesses < 20 mm are not monitored – deviations of the technical data are reserved.

The palletizing of our LINIREC construction boards is performed on solid wooden oneway pallets. The pallets are invoiced with 25,- € per pallet (Art.-Nº. 991).

Application areas

- suitable for thermal separation in buildings acc. to the Energy Performance of Buildings directive as well as in passive houses due to its good insulating properties
- thermal separation in facade construction
- connections for full thermal protection
- detailed solutions for pitched and flat roofs
- skirting board cladding of wood facades
- base paneling for timber facades
- as profiles and moldings
- filling of partition walls
- vehicle construction
- furniture manufacture (especially for wet rooms)

Benefits

- with European Technical evaluation ETA 19/0193*
- high thermal insulation
- hard, high mechanical strength
- moisture and mould resistant
- mildew resistant
- resistant to ageing
- non-rotting
- biological and building-ecological harmless
- resistant against mineral oils, acetone, methylene chloride, diluted alkalis and acids
- material can be processed using standard woodworking machines and tools

The LINIREC construction board consists of recycled PU rigid foam. The boards can be processed using standard woodworking machines and tools. The construction boards have a high mechanical strength and are resistant to moisture.

Furthermore the LINIREC construction boards ensure reliable and extremely durable solutions for pitched and flat roofs.

Trust the insulation material, which proves itself daily

LINITHERM consists of PU rigid foam, a polyurethane plastics. Countless small cells ensure that cold and heat can penetrate only very slowly. Polyurethane plastics are multifunctional, modern and secure. They can be adapted (to the designated use), in various forms, hard or soft. We use polyurethane daily – at home, in the office and in the car, during sports and on vacation.

Polyurethane is used ...

... in the cushioning of your couch



... in the dashboard, seat and steering wheel of your car



... in the soles of your shoes



... in your fridge



... in the mattress on which you sleep and much more.

Our insulation systems and building elements made of the high-performance insulation material PU rigid foam have many benefits:



THE HEALTHIER ROOF

Exemplary healthier building. Sustainable healthier living.



Low thermal conductivity λ_D 0.022 or λ_D 0.025 / 0.026 / 0.028.



Optimal cold and heat protection.



Maximum insulation with minimum panel thickness.



The insulation elements are easy to transport and can be installed quickly and easily, are pressure resistant (120 kPa) and dimensionally accurate & stable.



Moisture resistant, does not rot, resistant against fungi, microbes, does not decompose.



With LINITHERM insulation systems, one can receive solutions which will also fulfill higher requirements to noise protection.



PU rigid foam has an excellent mould resistance when performed properly. LINITHERM PAL SIL for the exterior wall insulation from the inside ensures with the room sided silicate board a surface which is insensitive to mould and moisture.



Low emissions and physiologically safe.



LINITHERM insulation systems PAL λ_D 0.022 ensure an excellent protection against electric smog.



Recyclable.



Save energy sustainably. Positive building biology.



C-s2, d0

The insulation systems based on PU rigid foam are offered with fire behavior classe E according to EN13501-1. Products marked with this symbol correspond to fire behavior class C-s2, d0, according to EN 13501-1 (equals the national construction supervisory designation: »of low flammability«).



Highest hail resistance class (5)



We provide 10 years of system warranty in case of using the LINITHERM accessory products in addition to our LINITHERM over rafter insulation system (Page 15 – Page 19: Products for airtightness, sealing, fixing, miscellaneous, roof window insulating frame). The installation instructions of company Linzmeier have to be observed and the roof construction has to be executed according to standards and specifications.

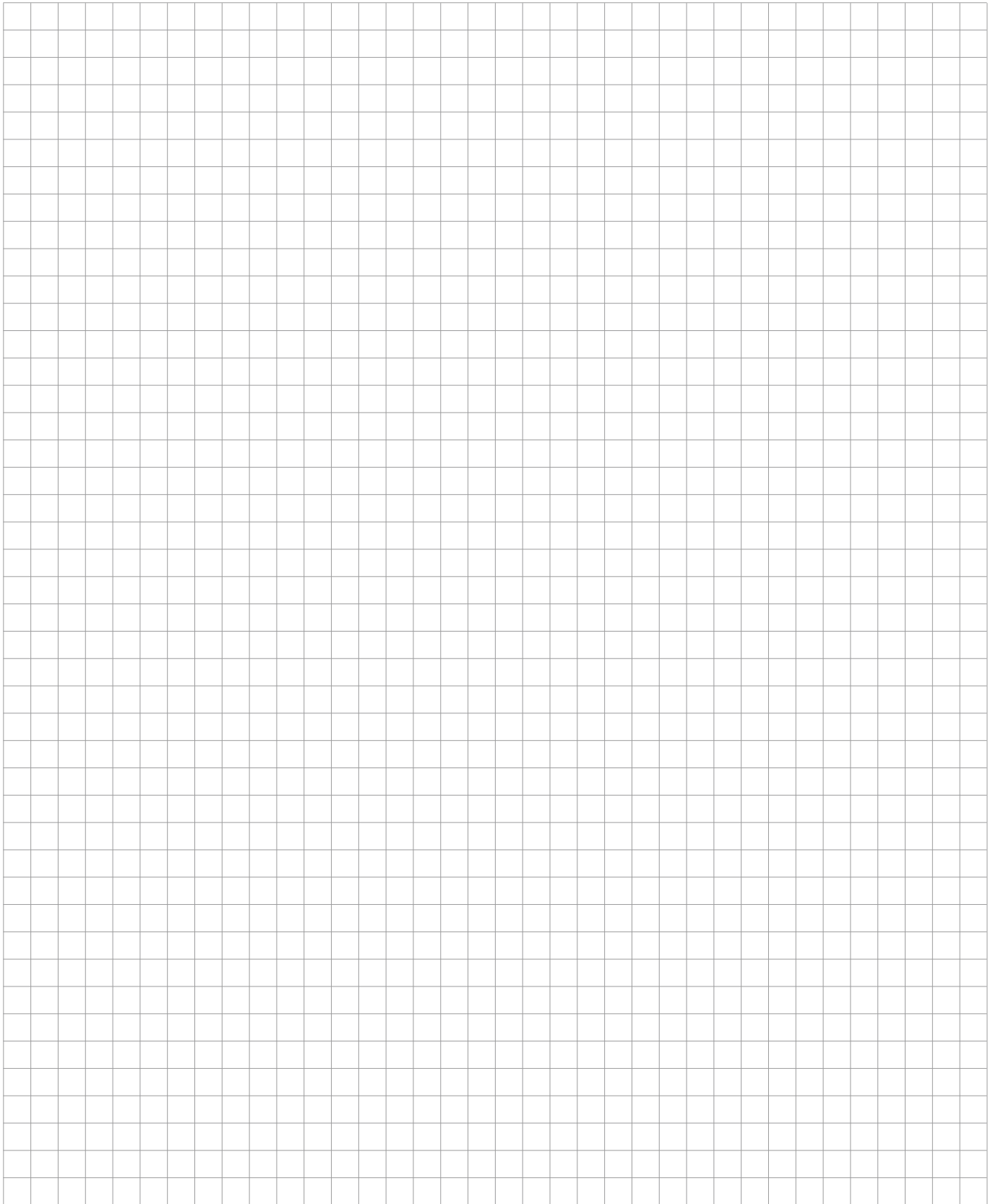

Price basis All prices are net in Euro and subject to statutory VAT.

Freight basis Deliveries abroad EXW ex works – without unload
(INCOTERMS@2020)
Freight charges upon request.

Delivery date Fixed dates are not possible. The delivery takes place with the time slot morning/afternoon. Schedule changes/postponements are possible up to 5 working days before the scheduled loading date. The agreed delivery dates are met by us as far as possible, however, they are always non-binding indications. Claims arising from delayed delivery or eventual damage compensation entitlements are excluded.

Validity of price Forementioned prices are valid until a new price list is published. After publication of this new price list all earlier versions are no longer valid. The prices are subject to change. The prices charged are based on those valid on the date of delivery. This price list is based on our general terms of purchasing, delivery and payment.

Packaging The palletizing of our LINITHERM insulation systems and LITEC building systems is performed on wooden oneway pallets or oneway foam pads. These will not be invoiced separately.

The palletizing of our LINIREC construction boards is performed on solid wooden oneway pallets. The pallets are invoiced with 25,- € per pallet.

Disposal PU rigid foam is free of HBCD.

Terms and conditions The order acceptance and delivery is based on our »General Terms and Conditions of Business for use in commercial transactions with businesses«.

Please find the current version of our GTC on the Internet for download at:
<https://www.linzmeier.de/en/company/terms>.

LINZMEIER

Insulate with system



DIN EN 13165 -
DIN 4108-10
PUR/PIR GEPRÜFT ÜGPU

For years our established LINITHERM insulation systems have been produced according to EN 13165 and are under regular control of the Überwachungsgemeinschaft Polyurethan-Hartschaum e.V., Stuttgart (Germany).



Meets the QNG requirements for prevention of hazardous substances in insulants. "pure life" is a seal of approval issued by the ÜGPU association.

The seal »pure life« is the new environment quality label for PU insulation. Only products which meet the strict criteria and come from a monitored production are allowed to carry the seal. The certification applies to PU insulation board.



LITEC building systems with integrated timber frame constructions are produced according to DIN 1052 and are subjected to continuous quality checks.



Produkt gelistet im
DGNB Navigator

The DGNB Navigator logo is awarded to building products that are listed in the DGNB Navigator, the DGNB's building product platform. The Navigator forms a transition to DGNB certification.



The bio-based raw material components of LINITHERM LOOP insulation systems are certified according to REDcert² with the verification procedure of the biomass balance approach.



The QNG seal is a building-related quality seal of the Federal Ministry of Housing, Urban Development and Building (BMWSB) and is recognised as proof of eligibility for the NH class. Our »Pure-Life« tested products fulfil the requirements of Annex 3.1.3 QNG / avoidance of harmful substances in insulation materials.



The Environmental Product Declaration according to DIN ISO 14025 provides a basis for sustainable construction and environmental assessment of buildings.



Thermal insulation is an important contribution to climate protection. Well insulated buildings need less fossil energy and therefore emit less CO₂. Better structural thermal insulation does not require thicker insulation layers, but more efficient insulation materials. High-performance insulation materials made of rigid polyurethane foam (PU) with its diverse application possibilities are the future technology for energy-efficient buildings. The IVPU industry association supports this.

Linzmeier Bauelemente GmbH
Industriestraße 21
D-88499 Riedlingen
Tel.: +49 (0) 73 71 18 06-0

Linzmeier Bauelemente GmbH
Schortentalstraße 24
D-07613 Königshofen/Thüringen
Tel.: +49 (0) 3 66 91 7 22-0

Info@Linzmeier.de
www.Linzmeier.de



BE / EN / Pricelist / 2026-04 / pdf
Subject to changes.
No liability for misprints.